

# TOOL HOLDERS

BT30 BT40 BT50

Secure clamping  
High precision

Precise fitting

Internal grinding  
Precision machining

High-precision machining compatible

Reduced vibration  
Finer craftsmanship

Quick tool change, high concentricity



Quench hardening



Premium steel



High wear resistance



Durable



Smooth engagement



High concentricity

# ER COLLET CHUCKS

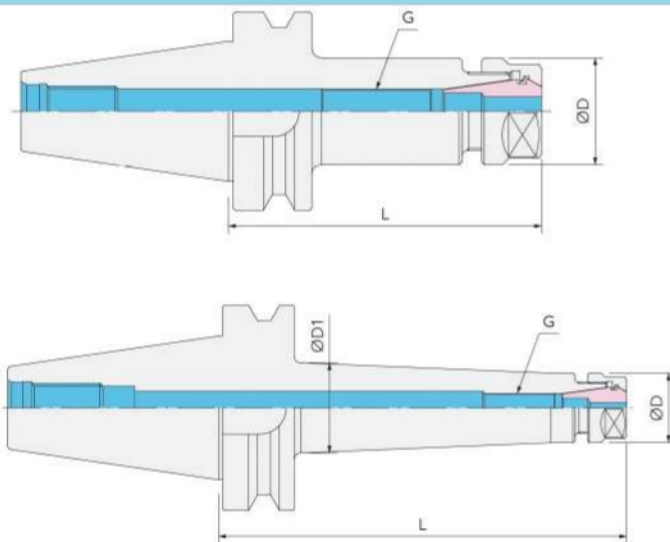

## Specifications

- ▶ Tensile strength: 930+ N/mm<sup>2</sup> (MPa)
- ▶ Inner hole precision: 0.003mm
- ▶ It has flexibility and is suitable for clamping drills, reamers, milling cutters, and threading tools.

訂購編號 Order No.	規格 Part No.	Fig.	Ø Range	ØD	L	G	螺帽 Nut	彈性筒夾 Collets	扳手 Wrench	庫存 Stock	牌價 P	備註2 Remark2
KEBKE311075	BT30-ER11-075	1	0.5-7.0	19	75	M08*P1.00	ER11SH	ER11	W-ER11		2380	
KEBKE311100	BT30-ER11-100	1	0.5-7.0	28	100	M08*P1.00	ER11SH	ER11	W-ER11		2440	
KEBKE316060	BT30-ER16-060	1	0.5-10.0	28	60	M11*P1.00	ER16SH	ER16	W-ER16		2220	
KEBKE316100	BT30-ER16-100	1	0.5-10.0	28	100	M11*P1.00	ER16SH	ER16	W-ER16		2320	
KEBKE320060	BT30-ER20-060	1	1.0-13.0	34	60	M14*P1.00	ER20SH	ER20	W-ER20		2300	
KEBKE320100	BT30-ER20-100	1	1.0-13.0	34	100	M14*P1.00	ER20SH	ER20	W-ER20		2380	
KEBKE320140	BT30-ER20-140	1	1.0-13.0	34	140	M14*P1.00	ER20SH	ER20	W-ER20		2560	
KEBKE325060	BT30-ER25-060	1	1.0-16.0	42	60	M18*P1.50	ER25SH	ER25	W-ER25		2370	
KEBKE325100	BT30-ER25-100	1	1.0-16.0	42	100	M18*P1.50	ER25SH	ER25	W-ER25		2470	
KEBKE332070	BT30-ER32-070	1	2.0-20.0	50	70	M10*P1.50	ER32SH	ER32	W-ER32		2500	
KEBKE332100	BT30-ER32-100	1	2.0-20.0	50	100	M24*P1.50	ER32SH	ER32	W-ER32		2610	

Inventory products

# ER COLLET CHUCKS

訂購編號 Order No.	規格 Part No.	Fig.	Ø Range	ØD	ØD1	L	G	螺帽 Nut	彈性筒夾 Collets	扳手 Wrench	庫存 Stock	牌價 P	備註2 Remark2
KEBE411075	BT40-ER11-075	1	0.5-7.0	19	-	75	M08*P1.00	ER11SH	ER11	W-ER11		2900	
KEBE411100	BT40-ER11-100	1	0.5-7.0	19	-	100	M08*P1.00	ER11SH	ER11	W-ER11		3050	
KEBE416070	BT40-ER16-070	1	0.5-10.0	28	-	70	M11*P1.00	ER16SH	ER16	W-ER16		2660	
KEBE416100	BT40-ER16-100	1	0.5-10.0	28	-	100	M11*P1.00	ER16SH	ER16	W-ER16		2940	
KEBE416120	BT40-ER16-120	1	0.5-10.0	28	-	120	M11*P1.00	ER16SH	ER16	W-ER16		3050	
KEBE416150	BT40-ER16-150	1	0.5-10.0	28	-	150	M11*P1.00	ER16SH	ER16	W-ER16		3550	
KEBE416200	BT40-ER16-200	2	0.5-10.0	28	38	200	M11*P1.00	ER16SH	ER16	W-ER16		3940	
KEBE420070	BT40-ER20-070	1	1.0-13.0	34	-	70	M14*P1.00	ER20SH	ER20	W-ER20		2760	
KEBE420100	BT40-ER20-100	1	1.0-13.0	34	-	100	M14*P1.00	ER20SH	ER20	W-ER20		3010	
KEBE420120	BT40-ER20-120	1	1.0-13.0	34	-	120	M14*P1.00	ER20SH	ER20	W-ER20		3180	
KEBE420150	BT40-ER20-150	1	1.0-13.0	34	-	150	M14*P1.00	ER20SH	ER20	W-ER20		3540	
KEBE420200	BT40-ER20-200	2	1.0-13.0	34	44	200	M14*P1.00	ER20SH	ER20	W-ER20		3960	
KEBE425070	BT40-ER25-070	1	1.0-16.0	42	-	70	M18*1.50	ER25SH	ER25	W-ER25		2780	
KEBE425100	BT40-ER25-100	1	1.0-16.0	42	-	100	M18*1.50	ER25SH	ER25	W-ER25		3080	
KEBE425120	BT40-ER25-120	1	1.0-16.0	42	-	120	M18*1.50	ER25SH	ER25	W-ER25		3300	
KEBE425150	BT40-ER25-150	1	1.0-16.0	42	-	150	M18*1.50	ER25SH	ER25	W-ER25		3740	
KEBE432070	BT40-ER32-070	1	2.0-20.0	50	-	70	M24*P1.50	ER32SH	ER32	W-ER32		2960	
KEBE432100	BT40-ER32-100	1	2.0-20.0	50	-	100	M24*P1.50	ER32SH	ER32	W-ER32		3220	
KEBE432120	BT40-ER32-120	1	2.0-20.0	50	-	120	M24*P1.50	ER32SH	ER32	W-ER32		3350	
KEBE432150	BT40-ER32-150	1	2.0-20.0	50	-	150	M24*P1.50	ER32SH	ER32	W-ER32		3890	
KEBE440080	BT40-ER40-080	1	2.5-26.0	63	-	80	M10*P1.50	ER40SH	ER40	W-ER40		3220	
KEBE440120	BT40-ER40-120	1	2.5-26.0	63	-	120	M28*P1.50	ER40SH	ER40	W-ER40		3730	
訂購編號 Order No.	規格 Part No.	Fig.	Ø Range	ØD	ØD1	L	G	螺帽 Nut	彈性筒夾 Collets	扳手 Wrench	庫存 Stock	牌價 P	備註2 Remark2
KEBE516100	BT50-ER16-100	1	0.5-10.0	28	-	100	M11*P1.00	ER16SH	ER16	W-ER16		3320	
KEBE516120	BT50-ER16-120	1	0.5-10.0	28	-	120	M11*P1.00	ER16SH	ER16	W-ER16		3460	
KEBE516150	BT50-ER16-150	1	0.5-10.0	28	-	150	M11*P1.00	ER16SH	ER16	W-ER16		3960	
KEBE516200	BT50-ER16-200	2	0.5-10.0	28	38	200	M11*P1.00	ER16SH	ER16	W-ER16		5000	
KEBE520100	BT50-ER20-100	1	1.0-13.0	34	-	100	M14*P1.00	ER20SH	ER20	W-ER20		3360	
KEBE520120	BT50-ER20-120	1	1.0-13.0	34	-	120	M14*P1.00	ER20SH	ER20	W-ER20		3510	
KEBE520150	BT50-ER20-150	1	1.0-13.0	34	-	150	M14*P1.00	ER20SH	ER20	W-ER20		4030	
KEBE520200	BT50-ER20-200	2	1.0-13.0	34	44	200	M14*P1.00	ER20SH	ER20	W-ER20		5140	
KEBE520250	BT50-ER20-250	2	1.0-13.0	34	54	250	M14*P1.00	ER20SH	ER20	W-ER20		5820	
KEBE525070	BT50-ER25-070	1	1.0-16.0	42	-	70	M18*1.50	ER25SH	ER25	W-ER25		3340	
KEBE525150	BT50-ER25-150	1	1.0-16.0	42	-	150	M18*1.50	ER25SH	ER25	W-ER25		3980	
KEBE525200	BT50-ER25-200	1	1.0-16.0	42	-	200	M18*1.50	ER25SH	ER25	W-ER25		5170	
KEBE532070	BT50-ER32-070	1	2.0-20.0	50	-	70	M24*P1.50	ER32SH	ER32	W-ER32		3250	
KEBE532100	BT50-ER32-100	1	2.0-20.0	50	-	100	M24*P1.50	ER32SH	ER32	W-ER32		3490	
KEBE532150	BT50-ER32-150	1	2.0-20.0	50	-	150	M24*P1.50	ER32SH	ER32	W-ER32		4060	
KEBE532200	BT50-ER32-200	2	2.0-20.0	50	60	200	M24*P1.50	ER32SH	ER32	W-ER32		5410	
KEBE532250	BT50-ER32-250	2	2.0-20.0	50	60	250	M24*P1.50	ER32SH	ER32	W-ER32		6110	
KEBE540080	BT50-ER40-080	1	2.5-26.0	63	-	80	M28*P1.50	ER40SH	ER40	W-ER40		3620	
KEBE540150	BT50-ER40-150	1	2.5-26.0	63	-	150	M28*P1.50	ER40SH	ER40	W-ER40		4440	
KEBE540250	BT50-ER40-250	1	2.5-26.0	63	-	250	M28*P1.50	ER40SH	ER40	W-ER40		6200	
KEBE550090	BT50-ER50-090	1	10.0-34.0	78	-	90	M10*P1.50	ER50SH	ER50	W-ER50		3990	
KEBE550150	BT50-ER50-150	1	10.0-34.0	78	-	150	M10*P1.50	ER50SH	ER50	W-ER50		4850	

Tool holder series

# ER COLLET CHUCKS-STRAIGHT SHANK

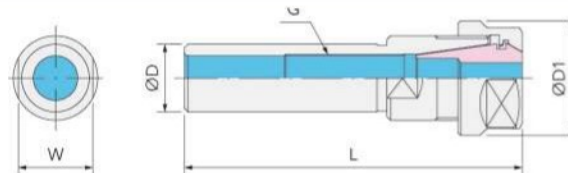

Fig1

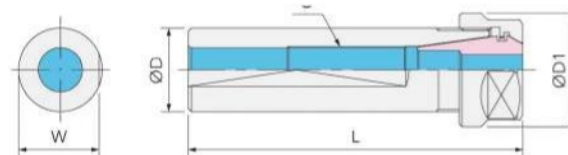

Fig2

## Specifications

- ▶ It provides strong locking force, ensuring higher precision and stability in tool clamping.
- ▶ Precision grinding enhances stability during cutting operations eliminating imbalance.

訂購編號 Order No.	規格 Part No.	Fig.	Ø Range	ØD	ØD1	L	G	W	螺帽 Nut	彈性筒夾 Collets	扳手 Wrench	庫存 Stock	牌價 P	備註2 Remark
KESTE1611150	ST16-ER11-150	1	0.5-7.0	16	19	150	M08*P1.00	16	ER11SH	ER11	W-ER11		2400	
KESTE2016100	ST20-ER16-100	1	0.5-10.0	20	28	100	M11*P1.00	19	ER16SH	ER16	W-ER16		2330	
KESTE2016150	ST20-ER16-150	1	0.5-10.0	20	28	150	M11*P1.00	19	ER16SH	ER16	W-ER16		2500	
KESTE2016200	ST20-ER16-200	1	0.5-10.0	20	28	200	M11*P1.00	19	ER16SH	ER16	W-ER16		2800	
KESTE2020100	ST20-ER20-100	1	1.0-13.0	20	34	100	M14*P1.00	22	ER20SH	ER20	W-ER20		2330	
KESTE2020150	ST20-ER20-150	1	1.0-13.0	20	34	150	M14*P1.00	22	ER20SH	ER20	W-ER20		2500	
KESTE2020200	ST-20-ER20-200	1	1.0-13.0	20	34	200	M14*P1.00	22	ER20SH	ER20	W-ER20		2800	
KESLE2520100	SL25-ER20-100	2	1.0-13.0	25	34	100	M14*P1.00	24	ER20SH	ER20	W-ER20		2400	
KESTE3220100	ST32-ER20-100	1	1.0-13.0	32	34	100	M14*P1.00	29	ER20SH	ER20	W-ER20		2500	
KESTE3220150	ST32-ER20-150	1	1.0-13.0	32	34	150	M14*P1.00	29	ER20SH	ER20	W-ER20		2700	
KESTE3220200	ST32-ER20-200	1	1.0-13.0	32	34	200	M14*P1.00	29	ER20SH	ER20	W-ER20		3000	
KESTE3225100	ST32-ER25-100	1	1.0-16.0	32	42	100	M18*P1.00	29	ER25SH	ER25	W-ER25		2700	
KESTE3225150	ST32-ER25-150	1	1.0-16.0	32	42	150	M18*P1.00	29	ER25SH	ER25	W-ER25		2900	
KESLE4025100	SL40-ER25-100	2	1.0-16.0	40	42	100	-	38	ER25SH	ER25	W-ER25		2850	
KESLE4032100	SL40-ER32-100	1	2.0-20.0	40	50	100	-	38	ER32SH	ER32	W-ER32		2850	

Inventory products

# ER COLLET CHUCKS-STRAIGHT SHANK

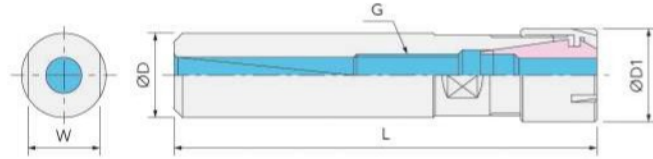

## Specifications

- ▶ It provides strong locking force, ensuring higher precision and stability in tool clamping.
- ▶ Precision grinding enhances stability during cutting operations eliminating imbalance.

訂購編號 Order No.	規格 Part No.	Ø Range	ØD	ØD1	L	G	W	螺帽 Nut	彈性筒夾 Collets	扳手 Wrench	庫存 Stock	牌價 P	備註2 Remark2
KESTEM1208150	ST12-ER08M-150	0.5-5.0	12	12	150	-	10	ER08M	ER08	W-ER08M		4600	
KESTEM1611150	ST16-ER11M-150	0.5-7.0	16	16	150	M08*P1.00	14	ER11M	ER11	W-ER11M		2600	
KESTEM2016100	ST20-ER16M-100	0.5-10.0	20	22	100	M11*P1.00	19	ER16M	ER16	W-ER16M		2400	
KESTEM2016150	ST20-ER16M-150	0.5-10.0	20	22	150	M11*P1.00	19	ER16M	ER16	W-ER16M		2670	
KESTEM2016200	ST20-ER16M-200	0.5-10.0	20	22	200	M11*P1.00	19	ER16M	ER16	W-ER16M		3000	
KESTEM2020100	ST20-ER20M-100	1.0-13.0	20	28	100	M14*P1.00	22	ER20M	ER20	W-ER20M		2670	
KESTEM2020150	ST20-ER20M-150	1.0-13.0	20	28	150	M14*P1.00	22	ER20M	ER20	W-ER20M		2820	
KESTEM2020200	ST20-ER20M-200	1.0-13.0	20	28	200	M14*P1.00	22	ER20M	ER20	W-ER20M		3100	

■ Inventory products

# NR HIGH SPEED PRECISION COLLET CHUCKS

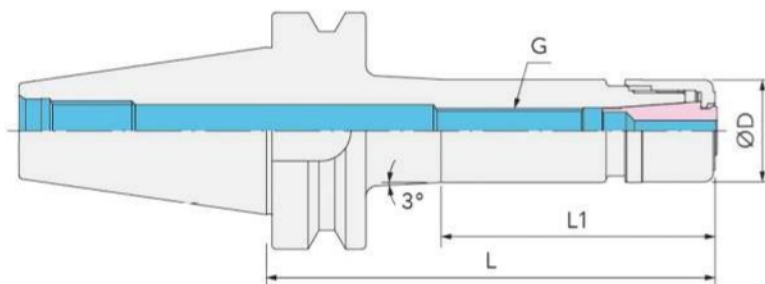

## Specifications

- ▶ It provides strong locking force, ensuring higher precision and stability in tool clamping.
- ▶ It is used for mold and high-speed machining applications.
- ▶ It eliminates the troubles caused by imbalance and high-speed rotational wind noise.
- ▶ Dynamic balance: 30000/G2.5

訂購編號 Order No.	規格 Part No.	Ø Range	ØD	L	L1	G	彈性筒夾 Collets	扳手 Wrench	庫存 Stock	牌價 P	備註2 Remark2
KNABN306060	BT30-NR06-060	3.0-6.0	19.5	60	-	M08*P1.25	NR06	W-D19.5		3200	
KNABN306090	BT30-NR06-090	3.0-6.0	19.5	90	-	M08*P1.25	NR06	W-D19.5		3400	
KNABN310060	BT30-NR10-060	3.0-10.0	27	60	-	M12*1.75	NR10	W-D27		3200	
KNABN310090	BT30-NR10-090	3.0-10.0	27	90	-	M12*1.75	NR10	W-D27		3400	
KNABN313060	BT30-NR13-060	3.0-13.0	34	60	-	M14*P1.00	NR13	W-D34		3300	
KNABN313090	BT30-NR13-090	3.0-13.0	34	90	-	M14*P1.00	NR13	W-D34		3500	
KNABN316060	BT30-NR16-060	3.0-16.0	40	60	-	M18*P1.50	NR16	W-D40		3400	
KNABN316090	BT30-NR16-090	3.0-16.0	40	90	-	M18*P1.50	NR16	W-D40		3600	

■ Inventory products

# NR HIGH SPEED PRECISION COLLET CHUCKS

訂購編號 Order No.	規格 Part No.	Ø Range	ØD	L	L1	G	彈性筒夾 Collets	扳手 Wrench	庫存 Stock	牌價 P	備註2 Remark2
KNABN406060	BT40-NR06-060	3.0-6.0	19.5	60	-	M08*P1.25	NR06	W-D19.5		3800	
KNABN406090	BT40-NR06-090	3.0-6.0	19.5	90	-	M08*P1.26	NR06	W-D19.5		4000	
KNABN406120	BT40-NR06-120	3.0-6.0	19.5	120	73	M08*P1.27	NR06	W-D19.5		4200	
KNABN406160	BT40-NR06-160	3.0-6.0	19.5	160	73	M08*P1.28	NR06	W-D19.5		4600	
KNABN410060	BT40-NR10-060	3.0-10.0	27	60	-	M12*1.75	NR10	W-D27		3800	
KNABN410090	BT40-NR10-090	3.0-10.0	27	90	-	M12*1.76	NR10	W-D27		4000	
KNABN410120	BT40-NR10-120	3.0-10.0	27	120	73	M12*1.77	NR10	W-D27		4200	
KNABN410160	BT40-NR10-160	3.0-10.0	27	160	96	M12*1.78	NR10	W-D27		4600	
KNABN410200	BT40-NR10-200	3.0-10.0	27	200	106	M12*1.79	NR10	W-D27		5000	
KNABN413060	BT40-NR13-060	3.0-13.0	34	60	-	M14*P1.00	NR13	W-D34		3900	
KNABN413090	BT40-NR13-090	3.0-13.0	34	90	-	M14*P1.01	NR13	W-D34		4100	
KNABN413120	BT40-NR13-120	3.0-13.0	34	120	-	M14*P1.02	NR13	W-D34		4300	
KNABN413160	BT40-NR13-160	3.0-13.0	34	160	-	M14*P1.03	NR13	W-D34		4700	
KNABN413200	BT40-NR13-200	3.0-13.0	34	200	-	M14*P1.04	NR13	W-D34		5100	
KNABN416060	BT40-NR16-060	3.0-16.0	40	60	-	M18*P1.50	NR16	W-D40		4000	
KNABN416090	BT40-NR16-090	3.0-16.0	40	90	-	M18*P1.51	NR16	W-D40		4200	
KNABN416120	BT40-NR16-120	3.0-16.0	40	120	-	M18*P1.52	NR16	W-D40		4400	
KNABN416160	BT40-NR16-160	3.0-16.0	40	160	-	M18*P1.53	NR16	W-D40		4800	
KNABN416200	BT40-NR16-200	3.0-16.0	40	200	-	M18*P1.54	NR16	W-D40		5200	
KNABN506105	BT50-NR06-105	3.0-6.0	19.5	105	-	M08*P1.26	NR06	W-D19.5		4400	
KNABN506135	BT50-NR06-135	3.0-6.0	19.5	135	68	M08*P1.27	NR06	W-D19.5		4870	
KNABN506165	BT50-NR06-165	3.0-6.0	19.5	165	68	M08*P1.28	NR06	W-D19.5		5270	
KNABN510105	BT50-NR10-105	3.0-10.0	27	105	-	M12*1.77	NR10	W-D27		4140	
KNABN510135	BT50-NR10-135	3.0-10.0	27	135	65	M12*1.78	NR10	W-D27		4800	
KNABN510165	BT50-NR10-165	3.0-10.0	27	165	77	M12*1.79	NR10	W-D27		5200	
KNABN513105	BT50-NR13-105	3.0-13.0	34	105	-	M14*P1.02	NR13	W-D34		4400	
KNABN513135	BT50-NR13-135	3.0-13.0	34	135	-	M14*P1.03	NR13	W-D34		4870	
KNABN513165	BT50-NR13-165	3.0-13.0	34	165	89	M14*P1.04	NR13	W-D34		5270	
KNABN516105	BT50-NR16-105	3.0-16.0	40	105	-	M18*P1.52	NR16	W-D40		4670	
KNABN516135	BT50-NR16-135	3.0-16.0	40	135	-	M18*P1.53	NR16	W-D40		4940	
KNABN516165	BT50-NR16-165	3.0-16.0	40	165	90	M18*P1.54	NR16	W-D40		5340	

Tool holder series

# C TYPE PRECISION POWER MILLING CHUCKS

Tool holder series

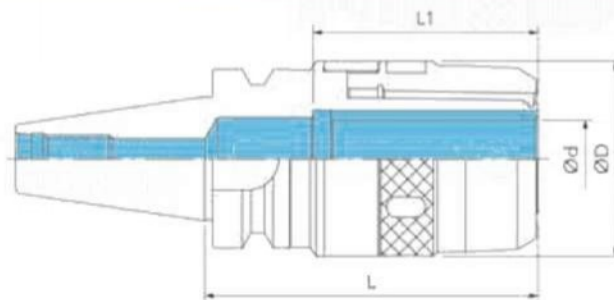

刀具柄部 (h6)  
Tool Shanks (h6)



## Specifications

- ▶ With its special dust-proof design, the tool holder increases the lifespan of the tool by over 50%.
- ▶ Caution: Exceeding the torque limit when tightening the nut can result in permanent damage to the tool shank, nut, or collet.

訂購編號 Order No.	規格 Part No.	Ød	ØD	L	L1	彈性筒夾 Collets	扳手 Wrench	庫存 Stock	牌價 P	備註2 Remark2
KCBC320085	BT30-C20-085	20	50	85	57.5	ARH20	W-FK08		6800	
KCBC420090	BT40-C20-090	20	50	90	57.5	ARH20	W-FK08		8200	
KCBC425090	BT40-C25-090	25	57	90	60	ARH25	W-FK09		8300	
KCBC432090	BT40-C32-090	32	69	90	64.5	ARH32	W-FK10		8500	
KCBC432105	BT40-C32-105	32	69	105	64.5	ARH32	W-FK10		9100	
KCBC432120	BT40-C32-120	32	69	120	64.5	ARH32	W-FK10		9500	
KCBC520105	BT50-C20-105	20	50	105	57.5	ARH20	W-FK08		8300	
KCBC520165	BT50-C20-165	20	50	165	57.5	ARH20	W-FK08		9570	
KCBC525105	BT50-C25-105	25	57	105	60	ARH25	W-FK09		8360	
KCBC525165	BT50-C25-165	25	57	165	60	ARH25	W-FK09		9630	
KCBC532105	BT50-C32-105	32	69	105	64.5	ARH32	W-FK10		8740	
KCBC532165	BT50-C32-165	32	69	165	64.5	ARH32	W-FK10		10070	

Inventory products

# APU CNC DRILL CHUCKS

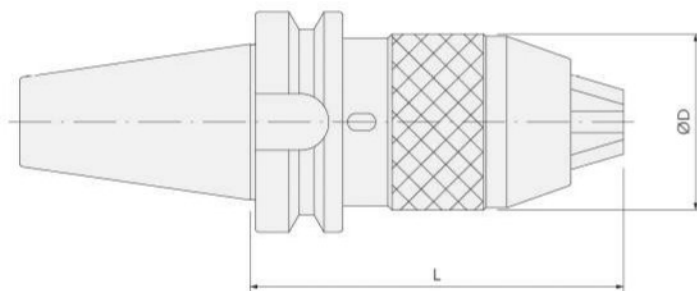

## Specifications

- ▶ The APU tool holder integrates the drill chuck and arbor into one unit, preventing the drill from falling or loosening during high-speed and heavy-duty cutting.
- ▶ Each APU tool holder is accompanied by one wrench.
- ▶ The wear resistance of the three-jaw chuck is increased by using a Tin coating.

訂購編號 Order No.	規格 Part No.	Ø Range	APU 夾頭 APU Drill Chuc	ØD	L	庫存 Stock	牌價 P	備註2 Remark2
KYBAPU308075	BT30-APU08-075	1-8	APU08	36.0	75		4820	
KYBAPU313110	BT30-APU13-110	1-13	APU13	50.5	110		4950	
KYBAPU408075	BT40-APU08-075	1-8	APU08	36.0	75		5120	
KYBAPU413090	BT40-APU13-090	1-13	APU13	50.5	90		5370	
KYBAPU413140	BT40-APU13-140	1-13	APU13	50.5	140		5850	
KYBAPU416130	BT40-APU16-130	3-16	APU16	57.0	130		6610	
KYBAPU508085	BT50-APU08-085	1-8	APU08	36.0	85		4340	
KYBAPU513100	BT50-APU13-100	1-13	APU13	50.5	100		4480	
KYBAPU513150	BT50-APU13-150	1-13	APU13	50.5	150		4980	
KYBAPU516130	BT50-APU16-130	3-16	APU16	57.0	130		5260	

■ Inventory products

# NR HIGH SPEED PRECISION COLLET CHUCKS-HSK

Tool holder series



## Specifications

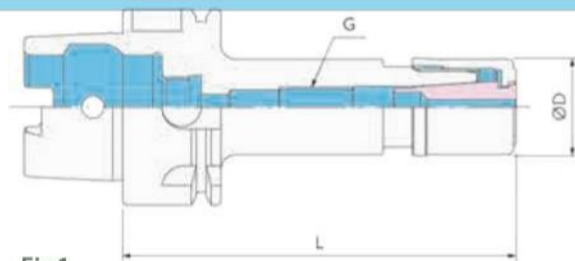

Fig1

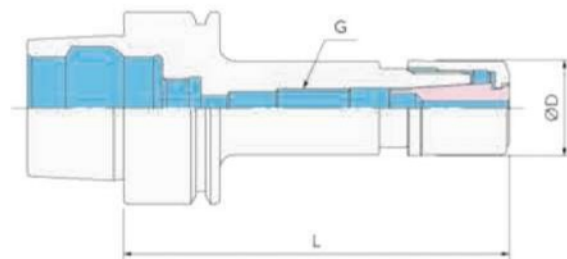

Fig2

- ▶ It provides strong locking force, ensuring higher precision and stability in tool clamping.
- ▶ It is used for mold and high-speed machining applications.
- ▶ It eliminates the troubles caused by imbalance and high-speed rotational wind noise.
- ▶ Dynamic balance: 30000/G2.5

訂購編號 Order No.	規格 Part No.	Fig.	Ø Range	ØD	L	G	彈性筒夾 Collets	扳手 Wrench	最高轉速 Max. rpm	庫存 Stock	牌價 P	備註2 Remark2
KNHN406060	HSK40E-NR06-060	1	3.0-6.0	19.5	60	-	NR06	W-D19.5	30,000		7000	
KNHN406080	HSK40E-NR06-080	1	3.0-6.0	19.5	80	M08*P1.25	NR06	W-D19.5	30000		7000	
KNHN410060	HSK40E-NR10-060	1	3.0-10.0	27	60	-	NR10	W-D27	30,000		6800	
KNHN410080	HSK40E-NR10-080	1	3.0-10.0	27	80	-	N10	W-D27	30000		7000	
KNHN413090	HSK40E-NR13-090	1	3.0-13.0	34	90	-	NR13	W-D34	30,000		7200	
KNHN416070	HSK40E-NR16-070	1	3.0-16.0	40	70	-	NR16	W-D40	30000		7000	
KNHN416090	HSK40E-NR16-090	1	3.0-16.0	40	90	-	NR16	W-D40	30,000		7400	
KNHN506060	HSK50A-NR06-060	2	3.0-6.0	19.5	60	-	NR06	W-D19.5	30000			Customs
KNHN506080	HSK50A-NR06-080	2	3.0-6.0	19.5	80	M08*P1.25	NR06	W-D19.5	30,000			Customs
KNHN510080	HSK50A-NR10-080	2	3.0-10.0	27	80	-	NR10	W-D27	30000			Customs
KNHN513090	HSK50A-NR13-090	2	3.0-13.0	34	90	-	NR13	W-D34	30,000			Customs
KNHN516100	HSK50A-NR16-100	2	3.0-16.0	40	100	M18*P1.50	NR16	W-D40	30000			Customs
KNHN606060	HSK63A-NR06-060	2	3.0-6.0	19.5	60	-	NR06	W-D19.5	30,000			Customs
KNHN606080	HSK63A-NR06-080	2	3.0-6.0	19.5	80	M08*P1.25	NR06	W-D19.5	30000			Customs
KNHN606100	HSK63A-NR06-100	2	3.0-6.0	19.5	100	M08*P1.25	NR06	W-D19.5	30,000			Customs
KNHN606120	HSK63A-NR06-120	2	3.0-6.0	19.5	120	M08*P1.25	NR06	W-D19.5	30000			Customs
KNHN610100	HSK63A-NR10-100	2	3.0-10.0	27	100	M12*P1.75	NR10	W-D27	30,000		6600	
KNHN613090	HSK63A-NR13-090	2	3.0-13.0	34	90	-	NR13	W-D34	30000			Customs
KNHN613120	HSK63A-NR13-120	2	3.0-13.0	34	120	M14*P1.00	NR13	W-D34	30,000			Customs
KNHN616120	HSK63A-NR16-120	2	3.0-16.0	40	120	M18*P1.50	NR16	W-D40	30000		7200	

Inventory products

# HC HIGH SPEED PRECISION COLLET CHUCKS

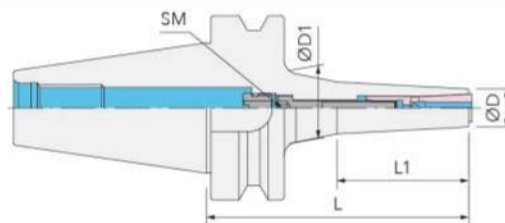

Fig1

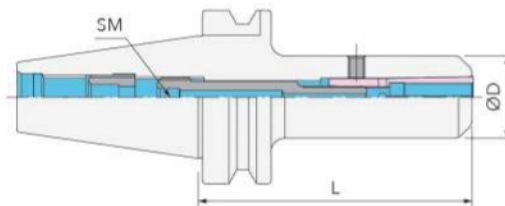

Fig2

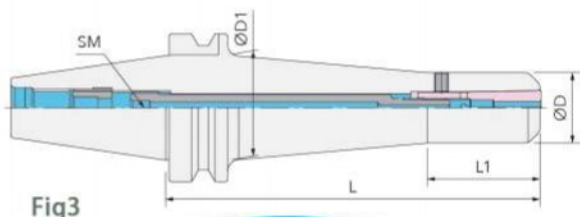

Fig3

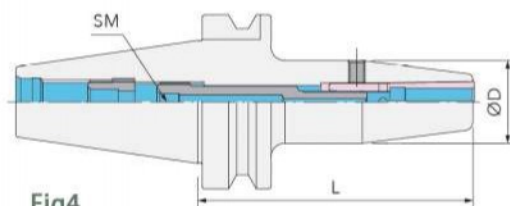

Fig4

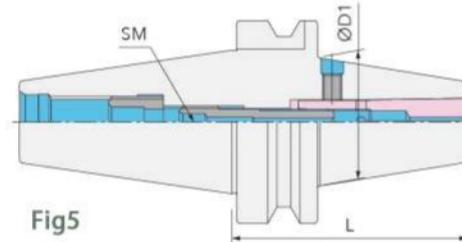

Fig5

Tool holder series

## Specifications

► It is suitable for high-speed light cutting operations and features a self-tightening function.

訂購編號 Order No.	規格 Part No.	Fig.	Ø Range	ØD	ØD1	L	L1	彈性筒夾 Collets	旋緊扭矩 Nm Tightening Torque	扳手 Wrench	庫存 Stock	牌價 P	備註2 Remark2
KNBHC306060	BT30-HC06-060	1	3.0-6.0	13	22	60	26	HC06	4	4mm		3400	
KNBHC306090	BT30-HC06-090	1	3.0-6.0	13	25	50	50	HC06	4	4mm		3800	
KNBHC310080	BT30-HC10-080	2	3.0-10.0	30	-	80	-	HC10	12	4mm		3800	
KNBHC316070	BT30-HC16-070	2	3.0-16.0	35	-	70	-	HC16	20	4mm		3800	
KNBHC406060	BT40-HC06-060	1	3.0-6.0	13	20	60	26	HC06	4	4mm		4500	
KNBHC406090	BT40-HC06-090	1	3.0-6.0	13	25	90	45	HC06	4	4mm		4800	
KNBHC406120	BT40-HC06-120	1	3.0-6.0	13	28	120	60	HC06	4	4mm		5360	
KNBHC406150	BT40-HC06-150	1	3.0-6.0	13	30	150	76	HC06	4	4mm		5600	
KNBHC410075	BT40-HC10-075	5	3.0-10.0	30	40	76.3	-	HC10	12	5mm		4900	
KNBHC410100	BT40-HC10-100	2	3.0-10.0	30	-	100	-	HC10	12	6mm		4900	
KNBHC410100S	BT40-HC10-100S	4	3.0-10.0	30	-	100	-	HC10	12	6mm		5000	
KNBHC4110160	BT40-HC10-160	3	3.0-10.0	30	45	160	48	HC10	12	6mm		5800	
KNBHC416100	BT40-HC16-100	2	6.0-16.0	35	-	100	-	HC16	20	6mm		5100	
KNBHC416100S	BT40-HC16-100S	4	6.0-16.0	35	-	100	-	HC16	20	6mm		5300	
KNBHC416160	BT40-HC16-160	3	6.0-16.0	35	45	160	63	HC16	20	6mm		6150	
KNBHC510100	BT50-HC10-100	2	3.0-10.0	30	-	100	-	HC10	12	6mm		6070	
KNBHC510160	BT50-HC10-160	3	3.0-10.0	30	43	160	48	HC10	12	6mm		7270	
KNBHC516100	BT50-HC16-100	2	6.0-16.0	35	-	100	-	HC16	12	6mm		6240	
KNBHC516160	BT50-HC16-160	3	6.0-16.0	35	43	160	63	HC16	20	6mm		7500	

Inventory products

# TRSN ANGLE HEAD CHUCKS , BT

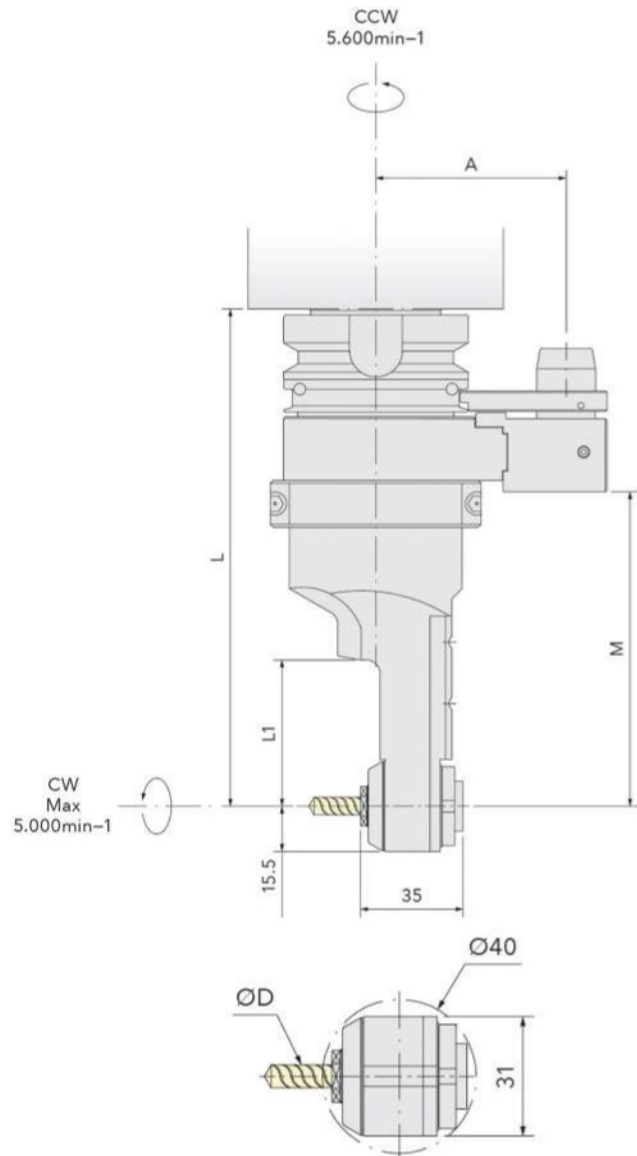

Tool holder series

## Specifications

- ▶ Spindle rotation should be opposite to the angle head.
- ▶ Please verify that the spindle rotates counterclockwise.

訂購編號 Order No.	規格 Spec	夾持範圍 Ø Range	A	L	L1	M	泛用精密筒夾 Precision Collets	最高轉數(min <sup>-1</sup> )(主軸：角軸) Max(min <sup>-1</sup> )(Main Spindle：Angle Shaft)	庫存 Stock	牌價 P	備註2 Remark2
KTBTRSNR306180	BT30-TRSNR6-180	3.0-6.0	75	180	50	107	NR06	5600:5000(1:0.88)		98000	
KTBTRSNR406180	BT40-TRSNR6-180	3.0-6.0	65	180	50	107	NR06	5600:5000(1:0.88)		98000	
KTBTRSNR506185	BT50-TRSNR6-185	3.0-6.0	80	185	50	107	NR06	5600:5000(1:0.88)		90200	

■ Inventory products

# UAH UNIVERSAL ANGLE HEAD CHUCKS, BT

Tool holder series

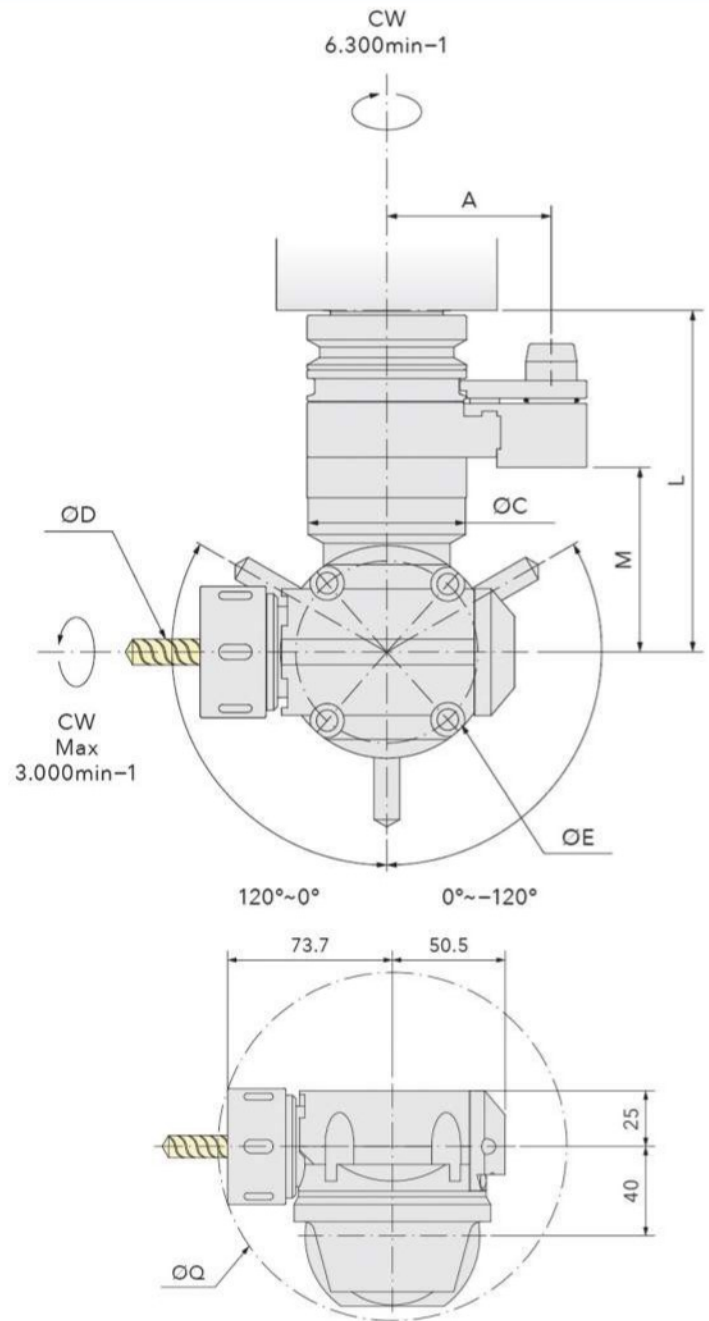

## Specifications

- ▶ Spindle rotation should match the angle head.
- ▶ Please verify that the spindle rotates clockwise.

訂購編號 Order No.	規格 Spec	夾持範圍 Ø Range	A	L	M	ØC	ØE	ØQ	彈性筒夾 Collets	最高轉數(min <sup>-1</sup> )(主軸:角軸) Max(min <sup>-1</sup> )(Main Spindle: Angle Shaft)	庫存 Stock	牌價 P	備註2 Remark2
KTBU432135	BT40-UAH-ER32-135	2.0~20.0	65	135	73	62	84	157	ER32	6.300:3.000(1:0.48)		98000	
KTBU532150	BT50-UAH-ER32-150	2.0~20.0	80	150	73	62	84	157	ER32	6.300:3.000(1:0.48)		90200	
KTHUB6332160	HSK63A-UAH-ER32-16	2.0~20.0	65	160	73	62	84	157	ER32	6.300:3.000(1:0.48)		110000	

Inventory products

# T90 ANGLE HEAD CHUCKS , BT

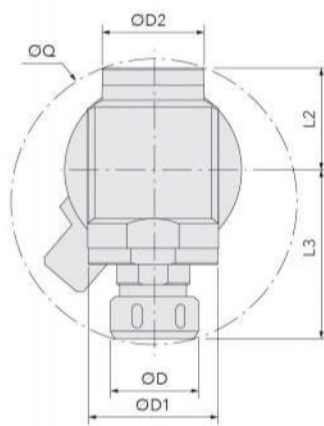
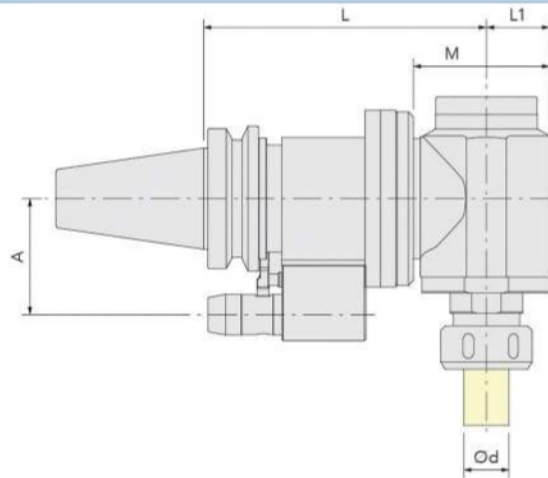

Fig.1

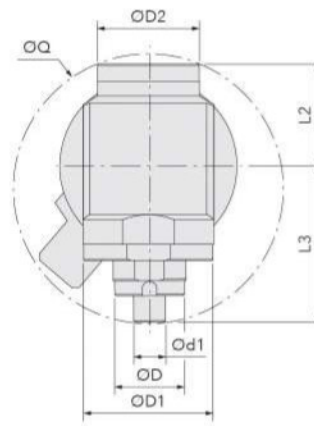

Fig.2

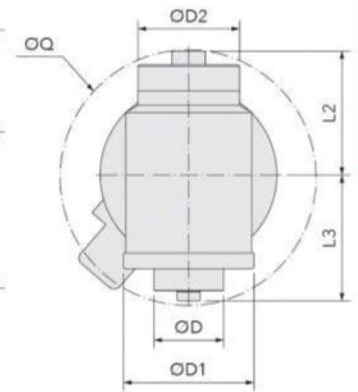

Fig.3

## Specifications

- ▶ Spindle: Counter-clockwise rotation (parameter: M04), Angle head axis: Clockwise rotation.
- ▶ The maximum allowable speed for gear ratio is BT40 - 1:0.81 and BT50 - 1:0.96.
- ▶ The maximum allowable spindle speeds are BT40-3000 RPM and BT50-2500 RPM.
- ▶ The maximum allowable speeds for the tool shank are BT40-2430 RPM and BT50-2400 RPM.
- ▶ Spindle rotation should be opposite to the angle head.
- ▶ Please verify that the spindle rotates counterclockwise.

訂購編號 Order No.	規格 Spec	Fig.	夾持範圍 Ø Range	Ød1	A	L	L1	L2	L3	M	ØD	ØD1	ØD2	ØQ	庫存 Stock	牌價 P	備註2 Remark2
KTBT49032160	BT40-TR90-ER32-160	1	2.0~20.0	-	65	160	40	65	95	86	50	88	65	171		106000	
KTBTC49025195	BT50-TR90-CTH25-195	1	3.0~25.0	-	80	195	44	70	110	97	63	90	70	193		95700	
KTBT49040195	BT50-TR90-ER40-195	1	2.5~26.0	-	80	195	44	70	110	97	63	90	70	193		95700	
KTBT549022195	BT50-TR90-SM22-195	2	-	22	80	195	44	70	108	97	48	90	70	190		95700	
KTBT59030195	BT50-TR90-TSA30-195	3	-	-	80	195	44	86	87	94	48	90	70	177		95700	

# TRH ANGLE HEAD CHUCKS, BT

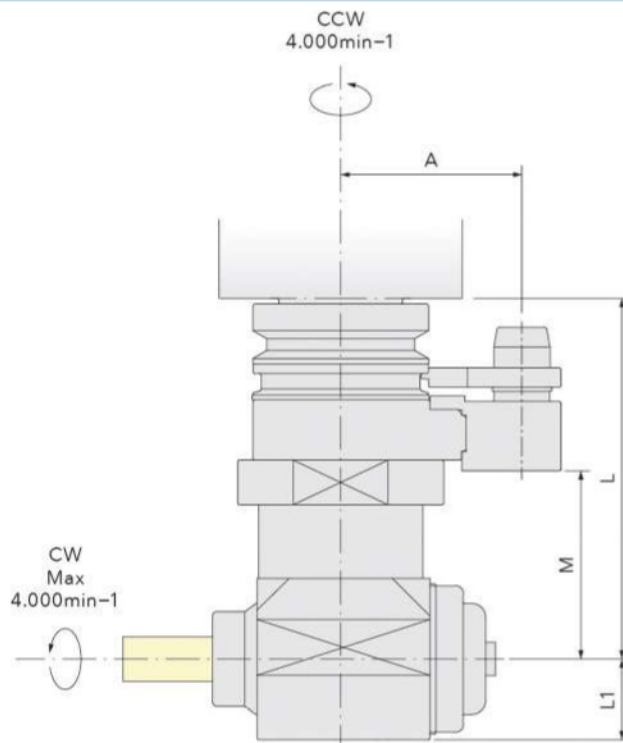

## Specifications

- ▶ It is suitable for high-speed light cutting.
- ▶ This tool holder has a self-tightening function.
- ▶ Spindle rotation should be opposite to the angle head.
- ▶ Please verify that the spindle rotates counterclockwise.

### TRH

訂購編號 Order No.	規格 Spec	夾持範圍 Ø Range	A	L	L1	L2	L3	M	ØD	ØD1	ØD2	ØQ	彈性筒夾 Collets	最高轉數(min⁻¹)(主軸:角軸) Max/min (Main Spindle / Angle Shaft)	庫存 Stock	售價 P	備註2 Remark2
KTBTTRCH316140	BT30-TRHC16-140	6.0-16.0	75	140	29	55.5	46	67.5	34	59	52.5	112	HC16	4000-4000 (1:1)		90000	
KTBTTRCH416130	BT40-TRHC16-130	6.0-16.0	65	129.5	29	55.5	46	67.5	34	59	52.5	112	HC16	4000-4000 (1:1)		90000	
KEBTTRCH516145	BT50-TRHC16-145	6.0-16.0	80	145	29	55.5	46	67.5	34	59	52.5	112	HC16	4000-4000 (1:1)		83600	

### TRN

訂購編號 Order No.	規格 Spec	夾持範圍 Ø Range	A	L	L1	L2	L3	M	ØD	ØD1	ØD2	ØQ	泛用精密筒夾 Precision Collets	最高轉數(min⁻¹)(主軸:角軸) Max/min (Main Spindle / Angle Shaft)	庫存 Stock	售價 P	備註2 Remark2
KTBTTRNR313140	BT30-TRNR13-140	3.0-13.0	75	150	29	46.7	43.2	67.5	35	59	52.5	100	NR13	4000-4000 (1:1)		98000	
KTBTTRNR413130	BT40-TRNR13-130	3.0-13.0	65	129.5	29	46.7	43.2	67.5	35	59	52.5	100	NR13	4000-4000 (1:1)		98000	
KTBTTRNR513145	BT50-TRNR13-145	3.0-13.0	80	145	29	46.7	43.2	67.5	35	59	52.5	100	NR13	4000-4000 (1:1)		90200	

Inventory products

# SLN WELDON CHUCKS, BT/ABT

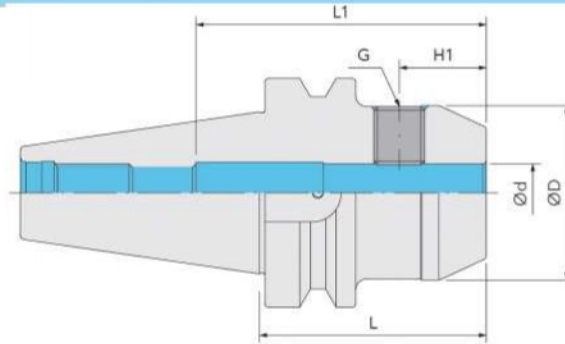

Fig. 1

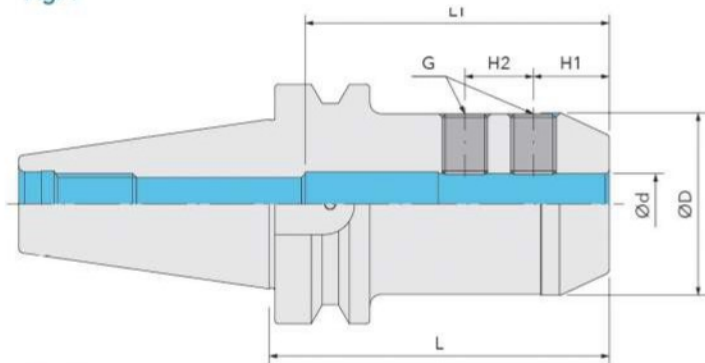

Fig. 2

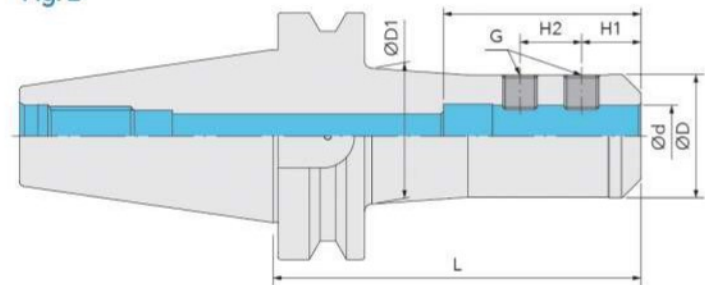

Fig. 3

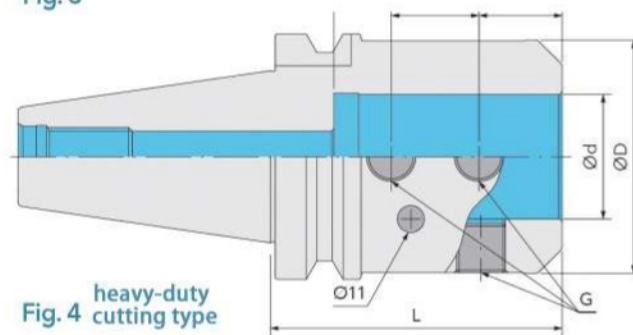

Fig. 4 heavy-duty cutting type

## Specifications

- ▶ Suitable for general milling operations with straight shank cutters
- ▶ Secure the tool with side set screws and position the cutting edge against the locking tool for heavy-duty machining.
- ▶ The tool holder offers secure grip without any tool slippage, even during heavy-duty machining.

訂購編號 Order No.	規格 Spec	Fig.	Ød	ØD	L	L1	H1	H2	G	庫存 Stock	牌價 P	備註2 Remark2
KHBSLN306050	BT30-SLN06-050	1	6	25	50	22	18	-	M06*P1.00		1600	
KHBSLN308060	BT30-SLN08-060	1	8	28	60	31	18	-	M08*P1.25		1600	
KHBSLN310060	BT30-SLN10-060	1	10	35	60	60	20	-	M10*P1.50		1600	
KHBSLN312060	BT30-SLN12-060	1	12	42	60	60	22.5	-	M12*P1.75		1600	
KHBSLN316060	BT30-SLN16-060	1	16	48	60	60	24	-	M14*P2.00		1600	
KHBSLN320080	BT30-SLN20-080	1	20	52	80	60	25	-	M16*P2.00		1700	
KHBSLN325080S	BT30-SLN25-080S	2	25	45	80	70	24	25	M10*P1.50		1700	
KHBSLN332095	BT30-SLN32-095	2	32	20	95	75	24	28	M14*P2.00		2100	
KHBSLN404075	BT40-SLN04-075	2	4	20	75	18	6	7	M04*P0.70		3150	
KHBSLN406050	BT40-SLN06-050	1	6	25	50	25	18	-	M06*P1.00		2050	
KHBSLN406075	BT40-SLN06-075	2	6	25	75	30	14	12	M06*P1.00		2200	
KHBSLN406090	BT40-SLN06-090	2	6	25	90	30	14	12	M06*P1.00		2260	
KHBSLN408050	BT40-SLN08-050	1	8	28	50	31	17	-	M08*P1.25		2000	
KHBSLN408075	BT40-SLN08-075	2	8	28	75	31	14	12	M08*P1.25		2100	
KHBSLN408090	BT40-SLN08-090	2	8	28	90	31	14	12	M08*P1.25		2200	
KHBSLN410063	BT40-SLN10-063	1	10	35	63	34	20	-	M10*P1.50		2000	
KHBSLN410090	BT40-SLN10-090	2	10	35	90	34	15	14	M08*P1.25		2200	
KHBSLN412063	BT40-SLN12-063	1	12	42	63	43	22.5	-	M12*P1.75		2100	
KHBSLN412090	BT40-SLN12-090	2	12	42	90	43	20	16	M12*P1.75		2250	
KHBSLN414063	BT40-SLN14-063	1	14	42	63	80	20	-	M12*P1.75		2200	
KHBSLN414090	BT40-SLN14-090	2	14	42	90	80	20	16	M12*P1.75		2300	
KHBSLN416063	BT40-SLN16-063	1	16	48	63	80	24	-	M14*P2.00		2100	
KHBSLN416090	BT40-SLN16-090	2	16	48	90	80	20	18	M12*P1.75		2250	
KHBSLN418063	BT40-SLN18-063	1	18	50	63	80	24	-	M14*P2.00		2200	
KHBSLN418090	BT40-SLN18-090	2	18	50	90	80	20	18	M12*P1.75		2300	
KHBSLN420063	BT40-SLN20-063	1	20	52	63	80	25	-	M16*P2.00		2100	
KHBSLN420090	BT40-SLN20-090	2	20	52	90	80	23	19	M12*P1.75		2300	
KHBSLN425090	BT40-SLN25-090	2	25	62	90	80	24	25	M18*P2.00		2500	
KHBSLN425090S	BT40-SLN25-090S	2	25	50	90	80	24	25	M14*P2.00		2400	
KHBSLN432110	BT40-SLN32-110	2	32	72	110	90	24	28	M20*P2.00		3000	
KHBSLN432100S	BT40-SLN32-100S	2	32	60	100	80	24	28	M14*P2.00		2500	
KHBSLN440100	BT40-SLN40-100	2	40	72	100	90	24	28	M14*P2.00		2800	
KHBSLN442100	BT40-SLN42-100	2	42	72	100	90	24	28	M14*P2.00		2800	

訂購編號 Order No.	規格 Spec	Fig.	Ød	ØD	ØD1	L	L1	H1	H2	G	庫存 Stock	牌價 P	備註2 Remark2
KHBSLN506063	BT50-SLN06-063	1	6	25	-	63	25	18	-	M0.6*P1.00		2520	
KHBSLN506090	BT50-SLN06-090	2	6	25	-	90	30	14	12	M0.6*P1.00		2880	
KHBSLN506150	BT50-SLN06-150	3	6	25	30	150	30	14	12	M0.6*P1.00		3620	
KHBSLN508063	BT50-SLN08-063	1	8	28	-	63	31	18	-	M08*P1.25		2520	
KHBSLN508090	BT50-SLN08-090	2	8	28	-	90	31	14	12	M08*P1.25		2930	
KHBSLN508150	BT50-SLN08-150	3	8	28	33	150	31	14	12	M08*P1.25		3600	
KHBSLN510080	BT50-SLN10-080	1	10	35	-	80	34	18	-	M10*P1.50		2640	
KHBSLN510100	BT50-SLN10-100	2	10	35	-	100	34	15	14	M08*P1.25		3030	
KHBSLN510150	BT50-SLN10-150	3	10	35	40	150	34	15	14	M08*P1.25		3600	
KHBSLN512080	BT50-SLN12-080	1	12	42	-	80	43	22.5	-	M12*P1.75		2660	
KHBSLN512100	BT50-SLN12-100	2	12	42	-	100	43	20	16	M12*P1.75		3060	
KHBSLN512150	BT50-SLN12-150	3	12	42	47	150	43	20	16	M12*P1.75		3620	
KHBSLN514100	BT50-SLN14-100	2	14	42	-	100	43	20	16	M12*P1.75		3060	
KHBSLN516080	BT50-SLN16-080	1	116	48	-	80	45	24	-	M14*P2.00		2670	
KHBSLN516100	BT50-SLN16-100	2	16	48	-	100	45	20	18	M12*P1.75		3050	
KHBSLN516150	BT50-SLN16-150	3	16	48	53	150	45	20	18	M12*P1.75		3650	
KHBSLN518100	BT50-SLN18-100	2	18	50	-	100	45	20	18	M12*P1.75		3060	
KHBSLN520080	BT50-SLN20-080	1	20	52	-	80	49	25	-	M16*P2.00		2670	
KHBSLN520100	BT50-SLN20-100	2	20	52	-	100	49	23	19	M12*P1.75		2060	
KHBSLN520150	BT50-SLN20-150	3	20	52	57	150	49	23	19	M12*P1.75		3660	
KHBSLN520200	BT50-SLN20-200	3	20	52	57	200	49	23	19	M12*P1.75		5110	
KHBSLN520250	BT50-SLN20-250	3	20	52	62	250	49	23	19	M12*P1.75		6600	
KHBSLN525105	BT50-SLN25-105	2	25	65	-	105	80	24	25	M18*P2.00		3270	
KHBSLN525100S	BT50-SLN25-100S	2	25	50	-	100	80	24	25	M14*P2.00		3120	
KHBSLN525150	BT50-SLN25-150	3	25	50	55	150	80	24	25	M14*P2.00		3780	
KHBSLN525200	BT50-SLN25-200	3	25	50	57	200	80	24	25	M14*P2.00		5440	
KHBSLN525250	BT50-SLN25-250	3	25	50	57	250	80	24	25	M14*P2.00		6900	
KHBSLN532105	BT50-SLN32-105	2	32	72	-	105	80	24	28	M20*P2.00		3270	
KHBSLN532105S	BT50-SLN32-105S	2	32	60	-	105	80	24	28	M14*P2.00		3150	
KHBSLN532150	BT50-SLN32-150	3	32	60	65	150	80	24	28	M14*P2.00		3810	
KHBSLN532200	BT50-SLN32-200	3	32	60	65	200	80	24	28	M14*P2.00		5470	
KHBSLN532250	BT50-SLN32-250	3	32	60	67	250	80	24	28	M14*P2.00		6900	
KHBSLN540120	BT50-SLN40-120	2	40	90	-	120	95	30	32	M20*P2.00		3720	
KHBSLN542120	BT50-SLN42-120	2	42	90	-	120	90	30	32	M20*P2.00		3720	
KHBSLN5412120S	BT50-SLN42-120S	2	42	70	-	120	90	30	32	M14*P2.00		3540	
KHBSLP5508120	BT50-SLP50.8-120	4	50.8	95	-	120	100	33.9	35.78	M20*P2.00		4940	

# ADAPTORS FOR THREADED SHANK END MILL, BT/ABT

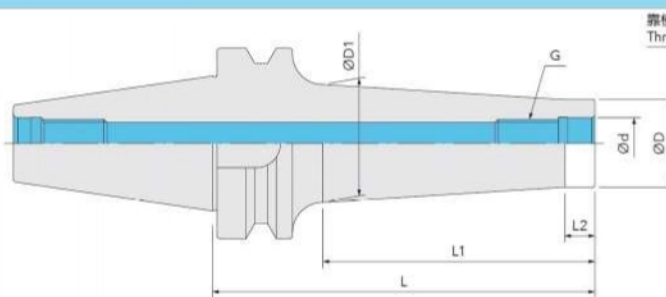

靠模铣刀頭—另購品  
Threaded Shank End-mill: Ordering Separately

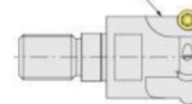

Tool holder series

## Specifications

- ▶ Adjustable in angle and position, it is ideal for precision cutting and contouring of complex-shaped workpieces.
- ▶ Ideal for high-speed machining, it ensures stable tool control for efficient and high-quality processing.

訂購編號 Order No.	規格 Spec	$\varnothing d$	$\varnothing D$	$\varnothing D1$	L	L1	L2	G	庫存 Stock	牌價 P	備註2 Remark2
KMBM406087	BT40-M06-087	6.5	9.8	20	87	50	10	M06*P1.00		2500	
KMBM408087	BT40-M08-087	8.5	13	23	87	50	10	M08*P1.25		2500	
KMBM410087	BT40-M10-087	10.5	18	25	87	50	10	M10*P1.50		2500	
KMBM412087	BT40-M12-087	12.5	21	24	87	50	10	M12*P1.75		2500	
KMBM416087	BT40-M16-087	17	29	34	87	50	10	M16*P2.00		2500	
KMBM416127	BT40-M16-127	17	29	39	127	90	10	M16*P2.00		3000	
KMBM512125	BT50-M12-125	12.5	21	35	125	75	10	M12*P1.75		3740	
KMBM516125	BT50-M16-125	17	29	34	125	75	10	M16*P2.00		3740	
KMBM516200	BT50-M16-200	17	29	48	200	150	10	M16*P2.00		4900	

Inventory products

# SCA SIDE CUTTER HOLDERS, BT/ABT

Tool holder series



## Specifications

▶ It is used in conjunction with a side milling cutter.

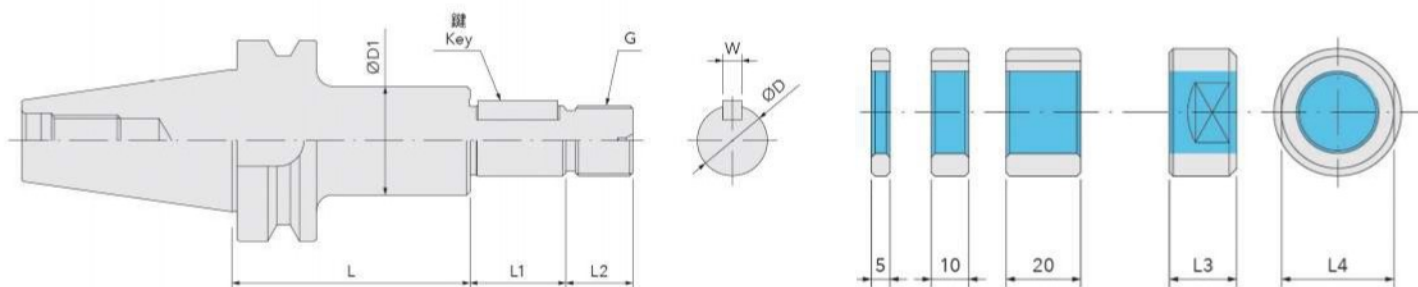

訂購編號 Order No.	規格 Spec	ØD	ØD1	L	L1	L2	L3	L4	G	W	Key	庫存 Stock	牌價 P	備註2 Remark2
KHBSCA322060	BT30-SCA22-060	22	34	60	30	21	18	30	M22*P1.50	6	6*6*25L		3500	
KHBSCA3254050	BT30-SCA25.4-050	25.4	40	50	30	25	21	32	M24*P2.00	6.35	6.35*6.35*25L		3200	
KHBSCA3254075	BT30-SCA25.4-075	25.4	40	75	30	25	21	32	M24*P2.00	6.35	6.35*6.35*25L		3200	
KHBSCA327060	BT30-SCA27-060	27	40	60	30	25	21	32	M25*P1.50	7	7*7*25L		3500	
KHBSCA422075	BT40-SCA22-075	22	34	75	30	21	18	30	M22*P1.50	6	6*6*25L		4300	
KHBSCA422120	BT40-SCA22-120	22	34	120	30	21	18	30	M22*P1.50	6	6*6*25L		4700	
KHBSCA4254075	BT40-SCA25.4-075	25.4	40	75	30	25	21	32	M24*P2.00	6.35	6.35*6.35*25L		4000	
KHBSCA4254120	BT40-SCA25.4-120	25.4	40	120	30	25	21	32	M24*P2.00	6.35	6.35*6.35*25L		4400	
KHBSCA4254075A	BT40-SCA25.4-075A	25.4	40	75	75	25	21	32	M24*P2.00	6.35	6.35*6.35*70L		4400	
KHBSCA427075	BT40-SCA27-075	27	40	75	30	25	21	32	M25*P1.50	7	7*7*25L		4300	
KHBSCA427120	BT40-SCA27-120	27	40	120	30	25	21	32	M25*P1.50	7	7*7*25L		4700	
KHBSCA432090	BT40-SCA32-090	32	46	90	30	30	26	36	M30*P2.00	8	8*8*25L		4800	
KHBSCA522090	BT50-SCA22-090	22	34	90	30	21	18	30	M22*P1.50	6	6*6*25L		5140	
KHBSCA522135	BT50-SCA22-135	22	34	135	30	21	18	30	M22*P1.50	6	6*6*25L		5670	
KHBSCA5254090	BT50-SCA25.4-090	25.4	40	90	30	25	21	32	M24*P2.00	6.35	6.35*6.35*25L		4940	
KHBSCA5254135	BT50-SCA25.4-135	25.4	40	135	30	25	21	32	M24*P2.00	6.35	6.35*6.35*25L		5470	
KHBSCA5254090A	BT50-SCA25.4-090A	25.4	40	90	75	25	21	32	M24*P2.00	7	6.35*6.35*70L		5470	
KHBSCA527090	BT50-SCA27-090	27	40	90	30	25	21	32	M25*P1.50	7	7*7*25L		5140	
KHBSCA527135	BT50-SCA27-135	27	40	135	30	25	21	32	M25*P1.50	7	7*7*25L		5670	
KHBSCA532090	BT50-SCA32-090	32	46	90	30	30	26	36	M30*P2.00	8	8*8*25L		5470	
KHBSCA532135	BT50-SCA32-135	32	46	135	30	30	26	36	M30*P2.00	8	8*8*25L		6000	
KHBSCA540090	BT50-SCA40-090	40	55	90	30	36	31	46	M36*P2.00	10	10*10*25L		5740	
KHBSCA540135	BT50-SCA40-135	40	55	135	30	36	31	46	M36*P2.00	10	10*10*25L		6400	

Inventory products

# SM SHELL MILL HOLDERS, BT/ABT

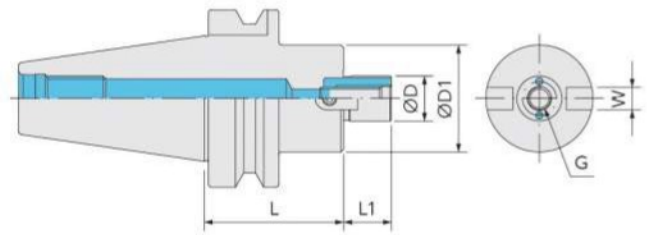

Fig. 1

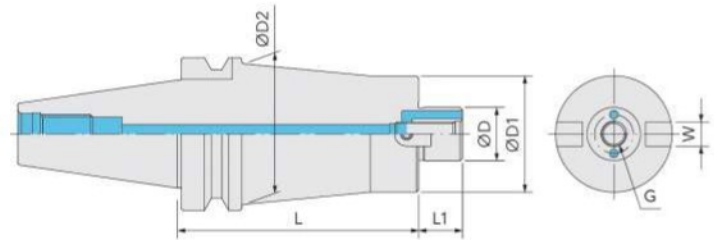

Fig. 2

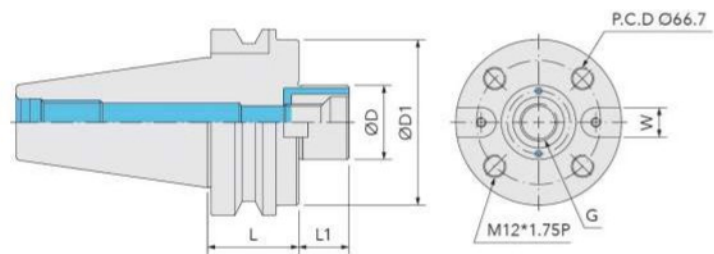

Fig. 3

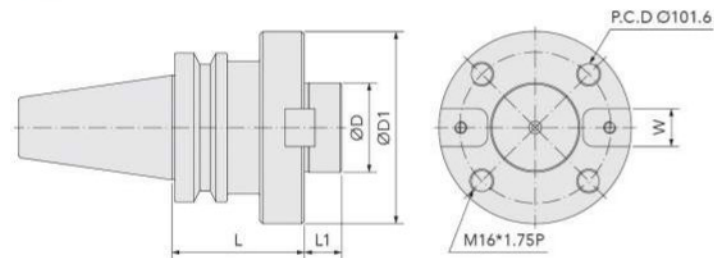

Fig. 4

## Specifications

- ▶ It is well-suited for high-speed cutting applications.
- ▶ It withstands high speeds and accelerations, ensuring excellent tool control for efficient and high-quality machining.

訂購編號 Order No.	規格 Spec	Fig.	ØD	ØD1	ØD2	L	L1	G	W	庫存 Stock	牌價 P	備註2 Remark2
KAABSM316050	BT30-SM16-050	1	16	38	-	50	16	M08*P1.25	8		1800	
KAABSM322050	BT30-SM22-050	1	22	48	-	50	18	M10*P1.50	10		1800	
KAABSM327050	BT30-SM27-050	1	27	52	-	50	20	M12*P1.75	12		1900	
KAABSM416050	BT40-SM16-050	1	16	38	-	50	16	M08*P1.25	8		2300	
KAABSM422055	BT40-SM22-055	1	22	48	-	55	18	M10*P1.50	10		2300	
KAABSM422100	BT40-SM22-100	1	22	48	-	100	18	M10*P1.50	10		2700	
KAABSM422150	BT40-SM22-150	2	22	48	58	150	18	M10*P1.50	10		3300	
KAABSM427055	BT40-SM27-055	1	27	58	-	55	20	M12*P1.75	12		2500	
KAABSM427100	BT40-SM27-100	1	27	58	-	100	20	M12*P1.75	12		2800	
KAABSM427130	BT40-SM27-130	1	27	58	-	130	20	M12*P1.75	12		3100	
KAABSM432060	BT40-SM32-060	1	32	62	-	60	23	M16*P2.00	14		2600	
KAABSM432100	BT40-SM32-100	1	32	62	-	100	23	M16*P2.00	14		3000	
KAABSM440060	BT40-SM40-060	1	40	88	-	60	27	M20*P2.50	15.875		4300	
KAABSM440100	BT40-SM40-100	3	40	88	-	100	27	M20*P2.50	15.875		4860	
KAABSM516050	BT50-SM16-050	1	16	38	-	50	16	M08*P1.25	8		3000	
KAABSM516150	BT50-SM16-150	1	16	38	-	150	16	M08*P1.25	8		5070	
KAABSM522060	BT50-SM22-060	1	22	48	-	60	18	M10*P1.50	10		3070	
KAABSM522100	BT50-SM22-100	1	22	48	-	100	18	M10*P1.50	10		3600	
KAABSM522150	BT50-SM22-150	2	22	48	60	150	18	M10*P1.50	10		4140	
KAABSM522200	BT50-SM22-200	2	22	48	62	200	18	M10*P1.50	10		4970	
KAABSM522250	BT50-SM22-250	2	22	48	68	250	18	M10*P1.50	10		6500	
KAABSM522300	BT50-SM22-300	2	22	48	73	300	18	M10*P1.50	10		8000	
KAABSM527060	BT50-SM27-060	1	27	58	-	60	20	M12*P1.75	10		3200	
KAABSM527100	BT50-SM27-100	1	27	58	-	100	20	M12*P1.75	12		3670	
KAABSM527150	BT50-SM27-150	2	27	58	68	150	20	M12*P1.75	12		4270	
KAABSM527200	BT50-SM27-200	2	27	58	68	200	20	M12*P1.75	12		5260	
KAABSM527250	BT50-SM27-250	2	27	58	68	250	20	M12*P1.75	12		6500	
KAABSM527300	BT50-SM27-300	2	27	58	73	300	20	M12*P1.75	12		8000	
KAABSM532060	BT50-SM32-060	1	32	78	-	60	23	M16*P2.00	14		3270	
KAABSM532100	BT50-SM32-100	1	32	78	-	100	23	M16*P2.00	14		3870	
KAABSM532150	BT50-SM32-150	2	32	78	88	150	23	M16*P2.00	14		4600	
KAABSM540060	BT50-SM40-060	3	40	89	-	60	27	M20*P2.50	15.875		3640	
KAABSM540100	BT50-SM40-100	3	40	89	-	100	27	M20*P2.50	15.875		4200	
KAABSM540150	BT50-SM40-150	3	40	89	-	150	27	M20*P2.50	15.875		5070	
KAABSM560090	BT50-SM60-090	4	60	129.1	-	90	25	-	25.4		5770	

# FMA FACE MILL HOLDERS, BT/ABT

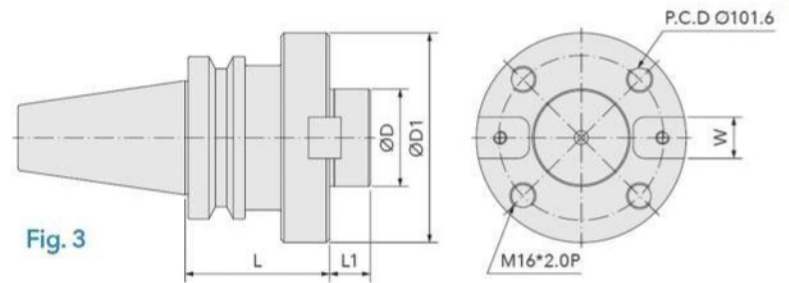
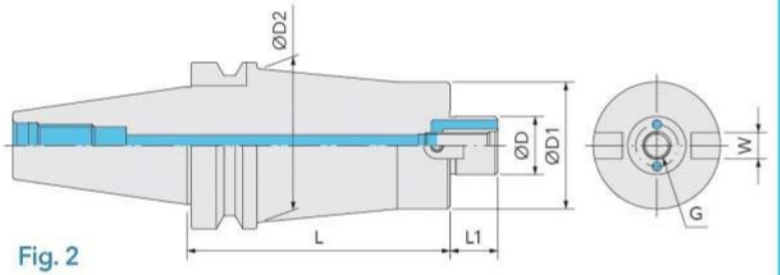
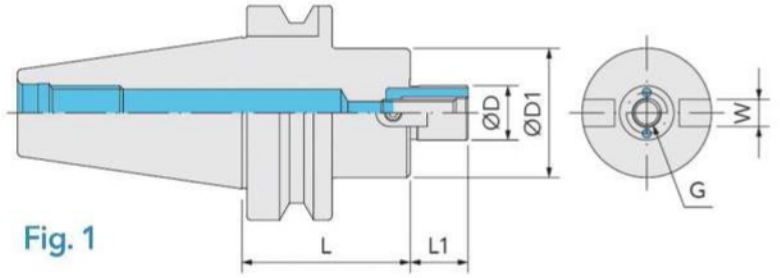

## Specifications

- ▶ It is used for flat machining, rapidly and precisely removing material from the workpiece surface to achieve flatness and surface quality.
- ▶ It is suitable for composite machining, capable of performing various cutting operations, reducing tool change time, and enhancing production efficiency.

訂購編號 Order No.	規格 Spec	Fig.	ØD	ØD1	ØD2	L	L1	G	W	庫存 Stock	牌價 P	備註2 Remark2
KABFMA3254050	BT30-FMA25.4-050	1	25.4	50	-	50	18	M12*P1.75	9.525		1900	
KABFMA4254045	BT40-FMA25.4-045	1	25.4	50	-	45	18	M12*P1.75	9.525		2300	
KABFMA4254075	BT40-FMA25.4-075	1	25.4	50	-	90	18	M12*P1.75	9.525		2700	
KABFMA4254150	BT40-FMA25.4-150	2	25.4	50	58	150	18	M12*P1.75	9.525		3300	
KABFMA43175045	BT40-FMA31.75-045	1	31.75	60	-	45	20	M16*P2.00	12.7		2500	
KABFMA43175075	BT40-FMA31.75-075	1	31.75	60	-	75	20	M16*P2.00	12.7		2800	
KABFMA43175130	BT40-FMA31.75-130	1	31.75	60	-	130	20	M16*P2.00	12.7		3200	
KABFMA4381060	BT40-FMA38.1-060	1	38.1	78	-	60	25	M20*P2.50	15.875		3300	

訂購編號 Order No.	規格 Spec	Fig.	ØD	ØD1	ØD2	L	L1	G	W	庫存 Stock	牌價 P	備註2 Remark2
KABFMA5254050	BT50-FMA25.4-050	1	25.4	50	-	53	18	M12*P1.75	9.525		3140	
KABFMA5254090	BT50-FMA25.4-090	1	25.4	50	-	90	18	M12*P1.75	9.525		3470	
KABFMA5254150	BT50-FMA25.4-150	2	25.4	50	60	150	18	M12*P1.75	9.525		4200	
KABFMA5254200	BT50-FMA25.4-200	2	25.4	50	70	200	18	M12*P1.75	9.525		5180	
KABFMA5254250	BT50-FMA25.4-250	2	25.4	50	70	250	18	M12*P1.75	9.525		6500	
KABFMA53175050	BT50-FMA31.75-050	1	31.75	60	-	53	20	M16*P2.00	12.7		3200	
KABFMA53175090	BT50-FMA31.75-090	1	31.75	60	-	75	20	M16*P2.00	12.7		3470	
KABFMA53175150	BT50-FMA31.75-150	1	31.75	60	-	105	20	M16*P2.00	12.7		3740	
KABFMA53175200	BT50-FMA31.75-200	2	31.75	60	70	150	20	M16*P2.00	12.7		4400	
KABFMA53175250	BT50-FMA31.75-250	2	31.75	60	75	200	20	M16*P2.00	12.7		5620	
KABFMA5381055	BT50-FMA38.1-055	1	38.1	78	-	55	25	M20*P2.50	15.875		3400	
KABFMA5381075	BT50-FMA38.1-075	1	38.1	78	-	75	25	M20*P2.50	15.875		3600	
KABFMA5381150	BT50-FMA38.1-150	2	38.1	78	88	150	25	M20*P2.50	15.875		4600	
KABFMA5508050	BT50-FMA50.8-050	1	50.8	98	-	48	25	M24*P3.00	19.05		3470	
KABFMA5508075	BT50-FMA50.8-075	1	50.8	98	-	75	25	M24*P3.00	19.05		3870	
KABFMA547625080	BT50-FMA47.625-080	3	47.625	128.57	-	83	30	-	25.4		5740	

■ Inventory products

# SHRINKFIT HOLDERS



# SHRINKFIT HOLDERS-HSK FORM A

Shrinkfit holders

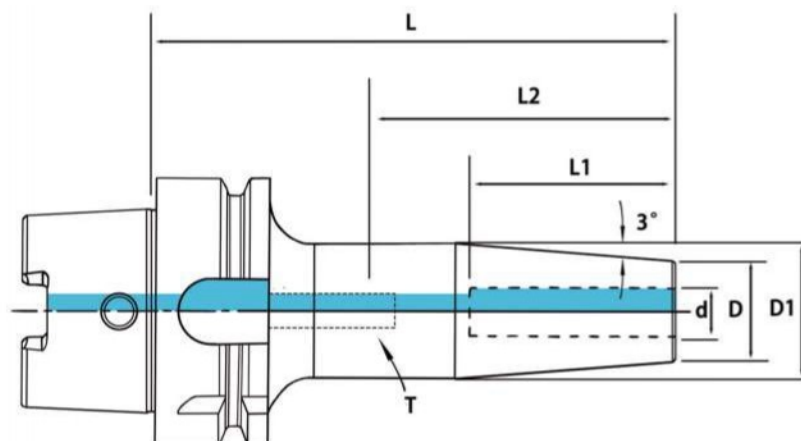

## Specifications

- ▶ Material: 100% German H13
- ▶ Dynamic balancing: 30000/G2.5
- ▶ Taper tolerance: AT3+
- ▶ Inner bore accuracy: 0.003mm
- ▶ Hardness: HRC52±2
- ▶ Applicable for solid carbide tools
- ▶ Applicable tool shank diameter tolerance: H6

訂購編號 Order No.	HSK A	Cutter	d	L	L2	L1	D	D1	T	庫存 Stock	備註2 Remark2
	A100	5	5	100	65	20	11	18	S10-502	24	
	A100	6	6	160	125	26	12	25	M5	29	
	A100	8	8	160	125	26	14	27	M6	27	
	A100	10	10	160	125	31	16	29	M8	30	
	A100	12	12	160	125	36	18	31	M10	29	
	A100	25	25	160	125	48	34	47	M16	29	

■ Inventory products

# SHRINKFIT HOLDERS-HSK FORM A 4.5°

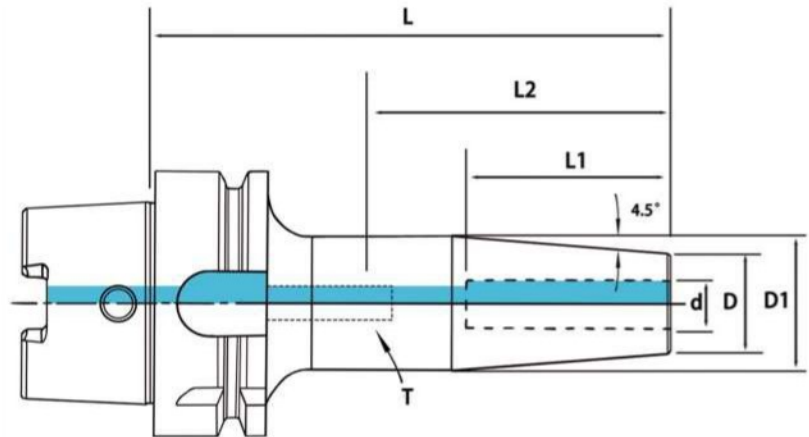

Shrinkfit holders

## Specifications

- ▶ Material: 100% German H13
- ▶ Dynamic balancing: 30000/G2.5
- ▶ Taper tolerance: AT3+
- ▶ Inner bore accuracy: 0.003mm
- ▶ Hardness: HRC52±2
- ▶ Applicable for solid carbide tools
- ▶ Applicable tool shank diameter tolerance: H6

訂購編號 Order No.	HSK A	Cutter	d	L	L2	L1	D	D1	T	庫存 Stock	牌價 P	備註2 Remark2
A100	6	6	6	160	38	26	21	27	M5	■	11600	
A100	8	8	8	160	38	26	21	27	M6	■	11600	
A100	10	10	10	160	51	31	24	32	M8	■	11600	
A100	12	12	12	160	51	36	24	32	M10	■	11600	
A100	16	16	16	100	44	39	27	34	M12	■	9800	
A100	25	25	25	85	57	48	44	53	M16	■	11000	
A100	25	25	25	160	57	48	44	53	M16	■	11600	
A100	32	32	32	85	57	48	44	53	M16	■	11000	
A100	32	32	32	160	57	48	44	53	M16	■	11600	

■ Inventory products

# SHRINKFIT HOLDERS-BT 3°

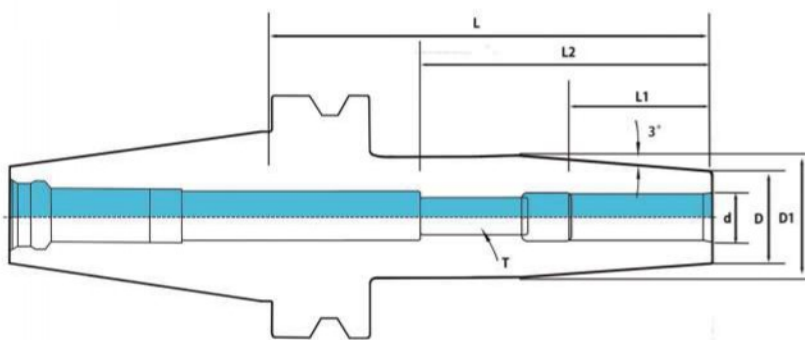

## Specifications

- ▶ Material: 100% German H13
- ▶ Dynamic balancing: 30000/G2.5
- ▶ Taper tolerance: AT3+
- ▶ Inner bore accuracy: 0.003mm
- ▶ Hardness: HRC52±2
- ▶ Applicable for solid carbide tools
- ▶ Applicable tool shank diameter tolerance: H6

訂購編號 Order No.	BT	Cutter	d	L	L2	L1	D	D1	T	庫存 Stock	牌價 P	備註2 Remark2
	BT40	3	3	100	70	15	9	17	S10-302			
	BT40	3	3	160	130	15	9	23	S10-303			
	BT40	4	4	100	70	16	10	18	S10-402			
	BT40	4	4	160	130	16	10	24	S10-403			
	BT40	6	6	100	70	26	12	20	M5			
	BT40	6	6	160	130	26	12	26	M5			
	BT40	8	8	100	70	26	14	22	M6			
	BT40	8	8	160	130	26	14	28	M6			
	BT40	10	10	100	70	31	16	24	M8			
	BT40	10	10	160	130	31	16	30	M8			
	BT40	12	12	100	70	36	18	26	M10			
	BT40	12	12	160	130	36	18	32	M10			
	BT40	16	16	100	70	39	22	30	M12			
	BT40	16	16	160	130	39	22	36	M12			
	BT40	20	20	100	70	41	27	35	M16			
	BT40	20	20	160	130	41	27	41	M16			

■ Inventory products

# SHRINKFIT HOLDERS-BT 4.5°

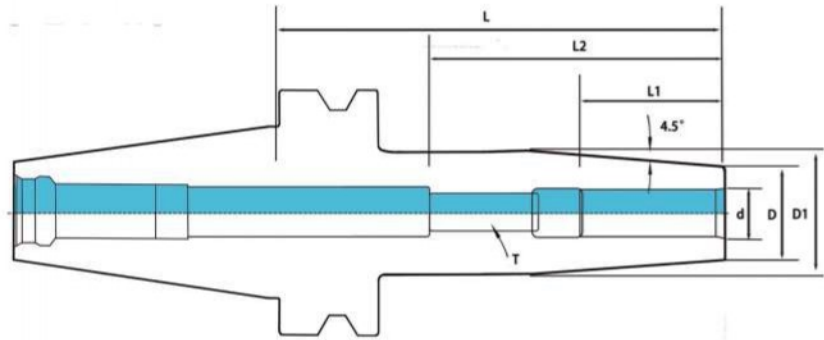

## Specifications

- ▶ Material: 100% German H13
- ▶ Dynamic balancing: 30000/G2.5
- ▶ Taper tolerance: AT3+
- ▶ Inner bore accuracy: 0.003mm
- ▶ Hardness: HRC52±2
- ▶ Applicable for solid carbide tools
- ▶ Applicable tool shank diameter tolerance: H6

訂購編號 Order No.	BT	Cutter	d	L	L2	L1	D	D1	T	庫存 Stock	牌價 P	備註2 Remark2
	BT30	3	3	70	35	15	10	16	S10			
	BT30	4	4	70	35	16	12	18	S10			
	BT30	6	6	70	35	22	21	27	M5			
	BT30	6	6	100	35	22	21	27	M5			
	BT40	3	3	80	48	15	10	18	S10			
	BT40	4	4	80	48	16	12	20	S10			
	BT40	6	6	90	38	22	21	27	M5			
	BT40	8	8	90	38	22	21	27	M6			
	BT40	10	10	90	59	31	24	33	M8			
	BT40	12	12	90	59	36	24	33	M10			
	BT40	16	16	90	57	36	27	36	M12			

■ Inventory products

# PS PULL STUDS(MAS-403)

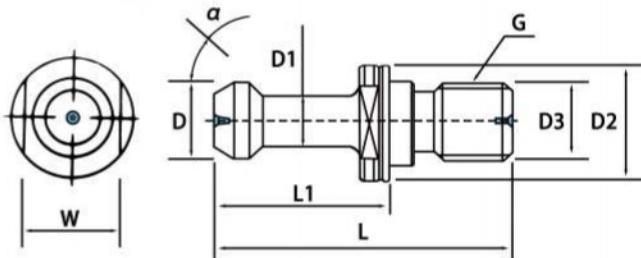

FIG.1

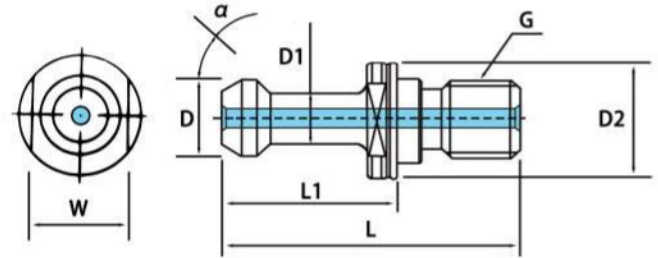

FIG.2

(Center coolant)

## Specifications

▶ Durable, high-quality pull studs with ground threads for BT tool holder extraction.

訂購編號 Order No.	Part No.	Fig.	D	D1	D2	D3	L	L1	$\alpha$ $\pm 15'$	G	W	最大旋緊扭矩 Max. Tighten Torque Kgf-M	庫存 Stock	牌價 P
KZAK3045	P30T-MAS1	1	11	7	16.5	12.5	43	23	45°	M12	13	2.0~2.5		200
KZAK3060	P30T-MAS2								60°					
KZAK3090	P30T-MAS3								90°					
KZAK4045	P40T-MAS1		15	10	23	17	60	35	45°	M16	19	6.0~8.0		200
KZAK4060	P40T-MAS2								60°					
KZAK4090	P40T-MAS3								90°					
KZAK5045	P50T-MAS1		23	17	38	25	85	45	45°	M24	30	20.0~25.0		380
KZAK5060	P50T-MAS2								60°					
KZAK5090	P50T-MAS3								90°					

訂購編號 Order No.	Part No.	Fig.	d	D	D1	D2	D3	L	L1	$\alpha$ $\pm 15'$	G	W	最大旋緊扭矩 Max. Tighten Torque Kgf-M	庫存 Stock	牌價 P
KZAKW3045	P30T-MAS1-H	2	2.5	11	7	16.5	12.5	43	23	45°	M12	13	2.0~2.5		220
KZAKW3060	P30T-MAS2-H									60°					
KZAKW3090	P30T-MAS3-H									90°					
KZAKW4045	P40T-MAS1-H		4	15	10	23	17	60	35	45°	M16	19	6.0~8.0		220
KZAKW4060	P40T-MAS2-H									60°					
KZAKW4090	P40T-MAS3-H									90°					
KZAKW5045	P50T-MAS1-H		7	23	17	38	25	85	45	45°	M24	30	20.0~25.0		400
KZAKW5060	P50T-MAS2-H									60°					
KZAKW5090	P50T-MAS3-H									90°					

■ Inventory products

# PS PULL STUDS(MAZAK)

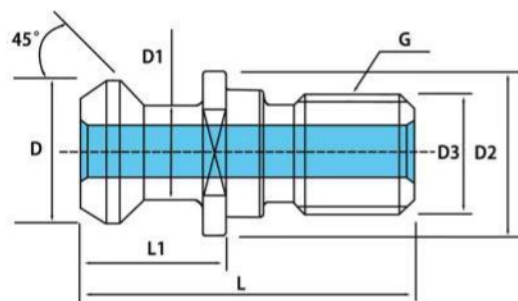
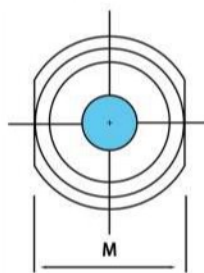

## Specifications

- ▶ Durable, high-quality pull studs with precision-ground threads for BT tool holder extraction.

訂購編號 Order No.	Part No.	d	D	D1	D2	D3	L	L1	G	W	最大旋緊扭矩 Max. Tighten Torque Kgf-M	庫存 Stock	牌價 P
KZAKM4045	MAZAK-BT40	7	18.8	12.5	22	17	44.1	19.1	M16	19	6.0~8.0		240
KZAKM5045	MAZAK-BT50	10	29	20.8	37	25	65.2	25.2	M24	30	20.0~25.0		500

■ Inventory products

# SK SPRING COLLET SYSTEM

## AA CLASS

SK Collet Series



High precision



Strong clamping force



High wear resistance

### Specifications

- ▶ Accuracy:  $\leq 0.005\text{mm}$
- ▶ The material is SUJ2 high carbon bearing steel, which possesses high hardness and toughness, resulting in a longer lifespan.
- ▶ Features: Widely used in boring, milling, drilling, CNC, and other machining operations.

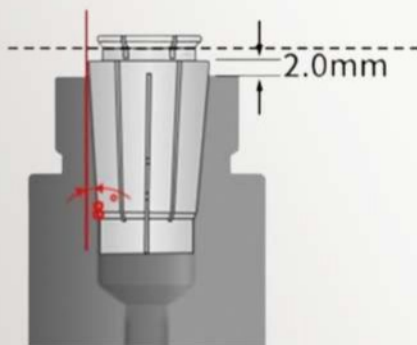

Low protrusion amount

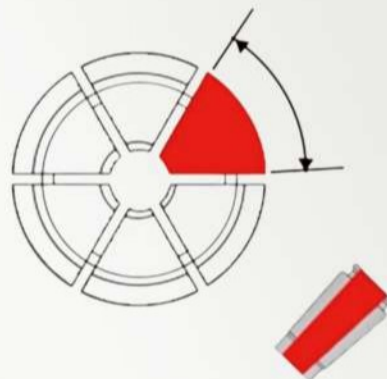

Large contact area

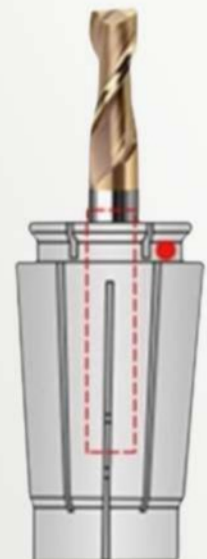

Single cone surface for greater stability

# Dimensions

TYPE	$\phi D$	L
SK06	10.5	25
SK10	15.5	30.5
SK13	20	39
SK16	24.5	45
SK20	28.5	54
SK25	35.5	57

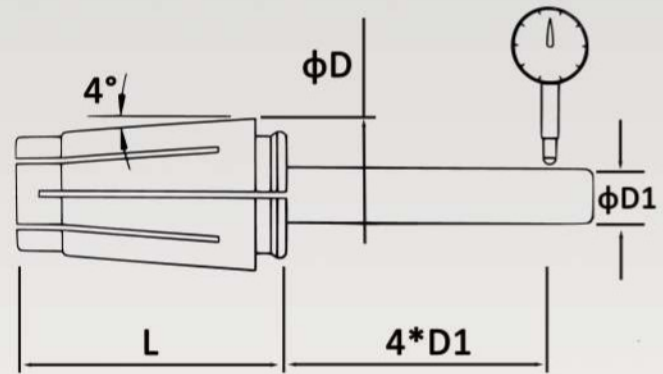

SK Collet Series

SK10 AA		
Order NO.	$\phi D1$	Price
JSK10030	3	900
JSK1003175	3.175	900
JSK10040	4	900
JSK10060	6	900
JSK10080	8	900
JSK10100	10	900

SK16 AA		
Order NO.	$\phi D1$	Price
JSK16030	3	1300
JSK16040	4	1300
JSK16060	6	1300
JSK16080	8	1300
JSK16100	10	1300
JSK16120	12	1300
JSK16160	16	1300

If you require other specifications or dimensions, please feel free to contact us for further inquiries



# STRAIGHT SPRING COLLET SYSTEM

Straight Collet Series



-  High polishing
-  Quenching and hardening
-  Strong clamping force
-  High concentricity
-  Bearing steel
-  High wear resistance

## Specifications

- ▶ Accuracy:  $\leq 0.01\text{mm}$ , Clamping Range: 3-25mm
- ▶ The product boasts seismic resistance, durability, and a strong clamping force. It undergoes internal diameter grinding to maintain excellent accuracy.
- ▶ Features: Widely used in boring, milling, drilling, CNC, and other machining operations.

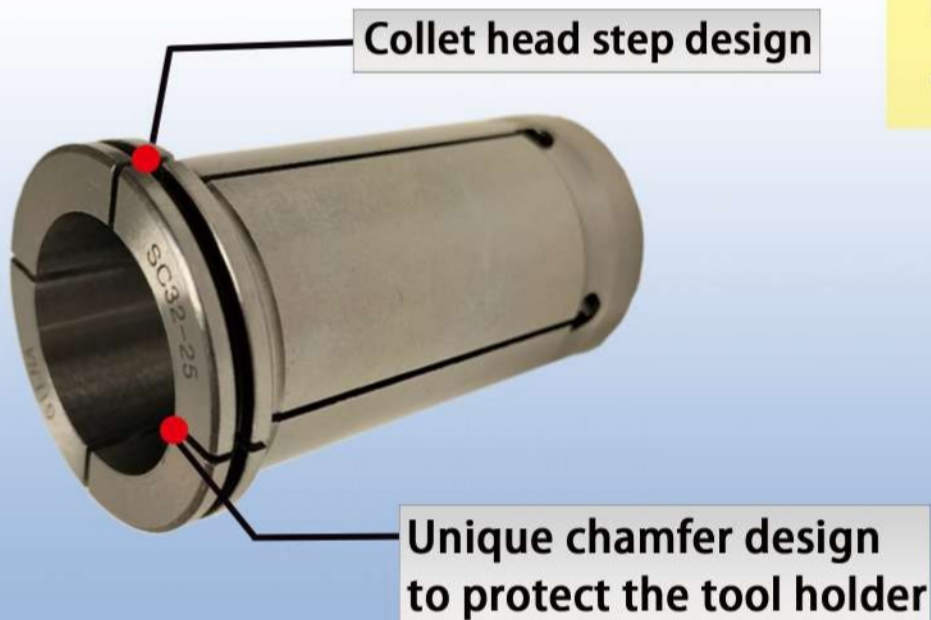

Four-groove design for tighter clamping force



# Dimensions

TYPE	D	D2	L
C20	25	20	52
C25	31	25	60
C32	37	33	73

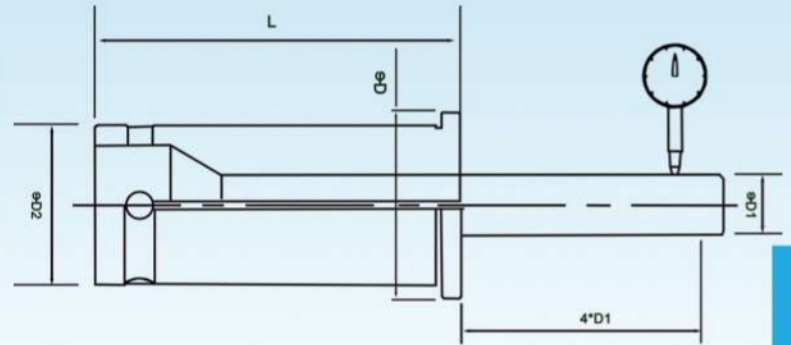

Straight Collet Series

C20		
Order No.	$\varphi$ D1	Price
JC20060	C20-6	420
JC20080	C20-8	420
JC20100	C20-10	420
JC20120	C20-12	420
JC20140	C20-14	420
JC20150	C20-15	420
JC20160	C20-16	420

C25		
Order No.	$\varphi$ D1	Price
JC25060	C25-6	460
JC25080	C25-8	460
JC25100	C25-10	460
JC25120	C25-12	460
JC25160	C25-16	460
JC25200	C25-20	460

C32		
Order No.	$\varphi$ D1	Price
JC32040	C32-4	580
JC32060	C32-6	580
JC32080	C32-8	580
JC32100	C32-10	580
JC32120	C32-12	580
JC32140	C32-14	580
JC32160	C32-16	580
JC32180	C32-18	580
JC32200	C32-20	580
JC32250	C32-25	580



**If you require other specifications or dimensions, please feel free to contact us for further inquiries**

# ER COLLET

DIN6499 ISO15488 collet

ER8 ER11 ER16 ER20 ER25 ER32

TIR: Grade  $\leq 0.008\text{mm}$

Deep cryogenic treatment  
at  $-187^{\circ}\text{C}$

High-carbon bearing steel

Unique chamfer design  
to prevent damage to nuts

Unique chamfer design  
to prevent damage to tool holders



[Precision Inspection]

## Specifications

- ▶ Material: SUJ2 high-carbon bearing steel, with a combination of hardness and toughness, providing excellent elasticity and longer service life.
- ▶ Hardness: HRC46°
- ▶ Applicable Range: Suitable for holding tools such as drill bits, taps, end mills, reamers, etc.

型號	D	D1	L	L1	L2
ER11	11.5	9.5	18	2.5	2
ER16	17	12.8	27.5	4	2.7
ER20	21	17.4	31.5	4.8	2.8
ER25	26	22	34	5	3.1
ER32	33	29.2	40	5.5	3.6
ER40	41	36.2	46	7	4.1

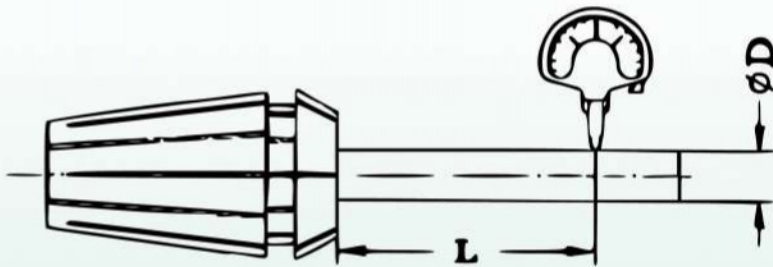
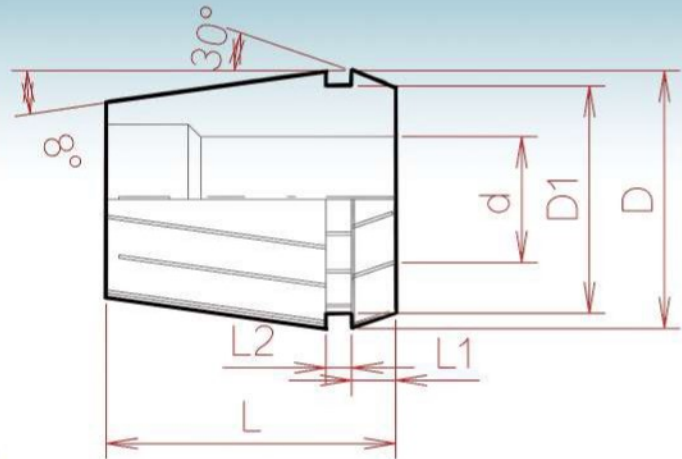

檢測條件		跳動精度
Test conditions		Beat accuracy
D	L	
1.0-1.4	6	0.008
1.5-2.9	10	0.008
3.0-5.9	16	0.008
6.0-9.9	25	0.008
10.0-17.9	40	0.008
18.0-26.9	50	0.008

## Exquisite Craftsmanship & Complete Specifications

ER08			
Order No.	NO.	Range	Price
JER08010	ER08-1.0	1	640
JER08015	ER08-1.5	1.5	640
JER08020	ER08-2.0	1.5~2.0	640
JER08025	ER08-2.5	2.0~2.5	640
JER08030	ER08-3.0	2.5~3.0	520
JER08035	ER08-3.5	3.0~3.5	520
JER08040	ER08-4.0	3.5~4.0	520
JER08045	ER08-4.5	4.0~4.5	520
JER08050	ER08-5.0	4.5~5.0	520

ER11			
Order No.	NO.	Range	Price
JER11010	ER11-1.0	1	520
JER11015	ER11-1.5	1.5	520
JER11020	ER11-2.0	1.5~2.0	520
JER11025	ER11-2.5	2.0~2.5	520
JER11030	ER11-3.0	2.5~3.0	420
JER11035	ER11-3.5	3.0~3.5	420
JER11040	ER11-4.0	3.5~4.0	420
JER11045	ER11-4.5	4.0~4.5	420
JER11050	ER11-5.0	4.5~5.0	420
JER11055	ER11-5.5	5.0~5.5	420
JER11060	ER11-6.0	5.5~6.0	420
JER11065	ER11-6.5	6.0~6.5	420
JER11070	ER11-7.0	6.5~7.0	420



**ER16**

Order No.	NO.	Range	Price
JER16010	ER16-1.0	0.5~1.0	520
JER16015	ER16-1.5	1.0~1.5	520
JER16020	ER10-2.0	1.0~2.0	520
JER16025	ER16-2.5	2.0~2.5	520
JER16030	ER16-3.0	2.0~3.0	520
JER16035	ER16-3.5	3.0~3.5	420
JER16040	ER16-4.0	3.0~4.0	420
JER16045	ER16-4.5	4.0~4.5	420
JER16050	ER16-5.0	4.0~5.0	420
JER16055	ER16-5.5	5.0~5.5	420
JER16060	ER16-6.0	5.0~6.0	420
JER16065	ER16-6.5	6.0~6.5	420
JER16070	ER16-7.0	6.0~7.0	420
JER16075	ER16-7.5	7.0~7.5	420
JER16080	ER16-8.0	7.0~8.0	420
JER16085	ER16-8.5	8.0~8.5	420
JER16090	ER16-9.0	8.0~9.0	420
JER16095	ER16-9.5	9.0~9.5	420
JER16100	ER16-10.0	9.0~10	420

**ER20**

Order No.	NO.	Range	Price
JER20010	ER20-1.0	0.5~1.0	520
JER20015	ER20-1.5	1.0~1.5	520
JER20020	ER20-2.0	1.0~2.0	520
JER20025	ER20-2.5	2.0~2.5	520
JER20030	ER20-3.0	2.0~3.0	420
JER20035	ER20-3.5	3.0~3.5	420
JER20040	ER20-4.0	3.0~4.0	420
JER20045	ER20-4.5	4.0~4.5	420
JER20050	ER20-5.0	4.0~5.0	420
JER20055	ER20-5.5	5.0~5.5	420
JER20060	ER20-6.0	5.0~6.0	420
JER20065	ER20-6.5	6.0~6.5	420
JER20070	ER20-7.0	6.0~7.0	420
JER20075	ER20-7.5	7.0~7.5	420
JER20080	ER20-8.0	7.0~8.0	420
JER20085	ER20-8.5	8.0~8.5	420
JER20090	ER20-9.0	8.0~9.0	420
JER20095	ER20-9.5	9.0~9.5	420
JER20100	ER20-10.0	9.0~10	420
JER20105	ER20-10.5	10~10.5	420
JER20110	ER20-11.0	10~11	420
JER20115	ER20-11.5	11~11.5	420
JER20120	ER20-12.0	11~12	420
JER20125	ER20-12.5	12~12.5	420
JER20130	ER20-13.0	12~13	420

**ER25**

Order No.	NO.	Range	Price
JER25020	ER25-02	1.0~2.0	640
JER25030	ER25-03	2.0~3.0	500
JER25040	ER25-04	3.0~4.0	500
JER25050	ER25-05	4.0~5.0	500
JER25060	ER25-06	5.0~6.0	500
JER25070	ER25-07	6.0~7.0	500
JER25080	ER25-08	7.0~8.0	500
JER25090	ER25-09	8.0~9.0	500
JER25100	ER25-10	9.0~10	500
JER25110	ER25-11	10~11	500
JER25120	ER25-12	11~12	500
JER25130	ER25-13	12~13	500
JER25140	ER25-14	13~14	500
JER25150	ER25-15	14~15	500
JER25160	ER25-16	15~16	500

**ER32**

Order No.	NO.	Range	Price
JER32020	ER32-2.0	1.0~2.0	640
JER32030	ER32-3.0	2.0~3.0	500
JER32040	ER32-4.0	3.0~4.0	500
JER32050	ER32-5.0	4.0~5.0	500
JER32060	ER32-6.0	5.0~5.0	500
JER32070	ER32-7.0	6.0~7.0	500
JER32080	ER32-8.0	7.0~8.0	500
JER32090	ER32-9.0	8.0~9.0	500
JER32100	ER32-10.0	9.0~10	500
JER32110	ER32-11.0	10~11	500
JER32120	ER32-12.0	11~12	500
JER32130	ER32-13.0	12~13	500
JER32140	ER32-14.0	13~14	500
JER32150	ER32-15.0	14~15	500
JER32160	ER32-16.0	15~16	500
JER32170	ER32-17.0	16~17	500
JER32180	ER32-18.0	17~18	500
JER32190	ER32-19.0	18~19	500
JER32200	ER32-20.0	19~20	500





Made in Taiwan

# CNC ACCESSORIES

Durable • Diverse variety • Self-developed

✓ Chip control expert  
Anti-Chip Strip

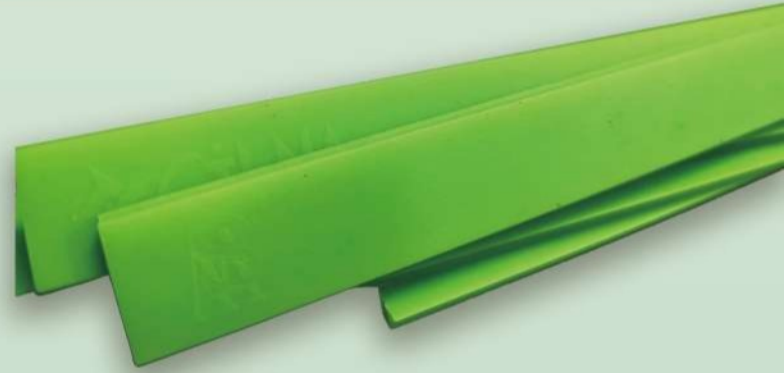

✓ Rust prevention assistant  
Rubber Chuck Sleeve

✓ Machining assistant

Wide variety, improved efficiency





# Anti-Chip Strip

For CNC Milling Machine

## PROPERTIES

- Oil Resistant
- Cuttable and Easy to Use
- Resistant Heat Up to 300 Degree
- Easy to Clean Out the Metal Chips

訂購編號 Order No.	寬度 W	長度 L	材質 M	牌價 P
LGB1820	18mm	200mm	矽膠 SILICONE	1600
LGB1420	14mm	200mm	矽膠 SILICONE	1600

✓ A set of 20 pieces.

Accessories



Copyright © 2022 Guanlin Machinery Co.,Ltd.

Made in Taiwan



# Anti-Rust

## Rubber BT40 Chuck Tool Holder Sleeve

Copyright © 2022 Guanlin Machinery Co.,Ltd.



Waterproof



Patent Number: M573265

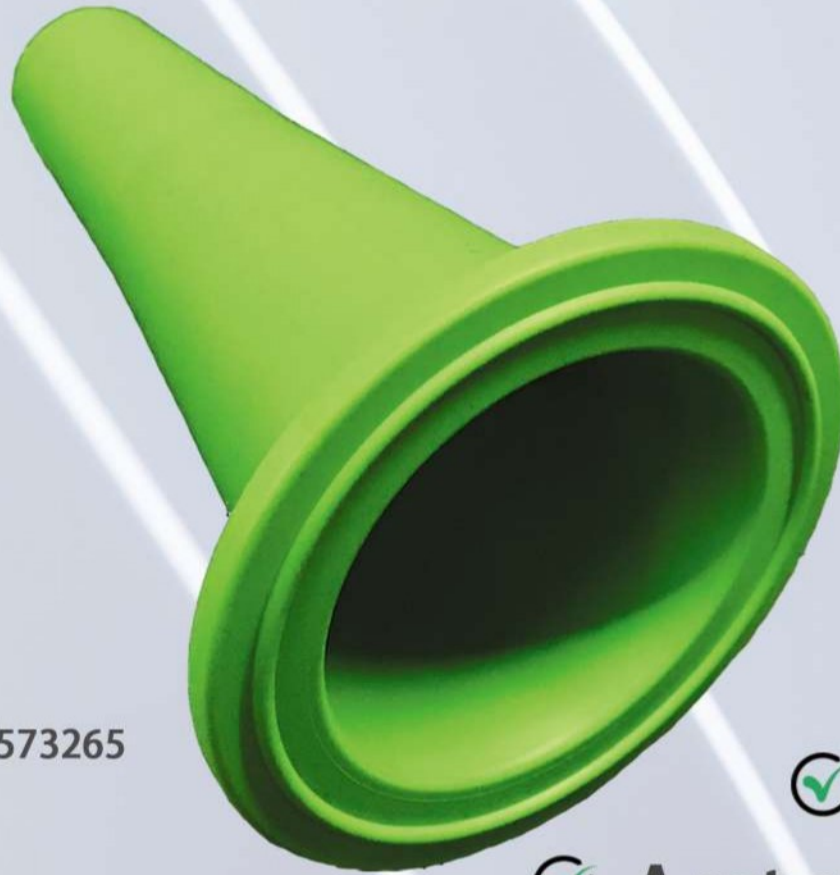

✓ NT\$1600

✓ A set of 10 pieces

### Good Helper For Chuck Holder Storage

Our product could help to block the moisture in the air, and the soft rubber protects your chucks and keeps them in place when not in use.

There are eight small holes at the bottom where oil and water could drip from, so that AT2/AT3 Class Tool Holders will maintain longer accuracy.



Made in Taiwan

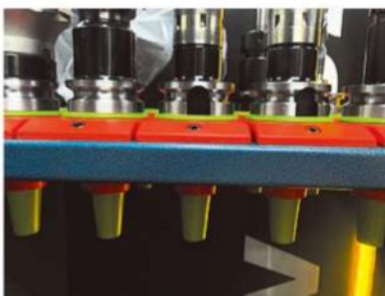

# Z AXIAL PRESET GAUGE



Pic1.

• KWMMSDK-50



Pic2.

• KWMNZM-50



Pic3.

• KWMNZH-50

## Specifications

- ▶ Setting up tools on computer milling machines/lathes.
- ▶ Height measurement:  $50.00 \pm 0.005$ mm.
- ▶ Small spring force prevents tool breakage.

訂購編號 Order No.	規格 Spec	高度 Height(mm)	測量面值徑 (mm)	Magnetic base	庫存 Stock	牌價 P	備註2 Remark2
KWMMSDK50S	MDSK-50A	50	44	✓			Pic1
KWMNZM50A	NZM-50A	50	48	✓			Pic2
KWMNZM50B	NZM-50B	50	48	-			Pic2
KWMNZH50A	NZH-50A	50	63	✓			Pic3
KWMNZH50B	NZH-50B	50	63	-			Pic3

# TOOL HOLDER LOCKING DEVICE

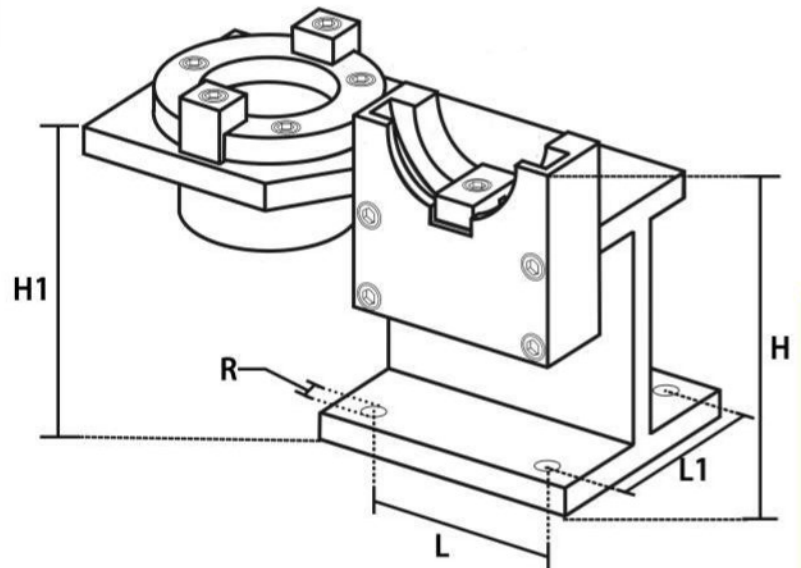

Accessories

## Specifications

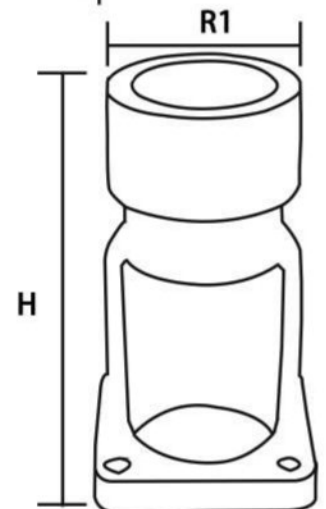

HSK63

- ▶ Stable and secure due to precision machining of the base and tool holder sleeve.
- ▶ Applicable tool holders: BT 30/40/50.
- ▶ Versatile and adaptable for both vertical and horizontal use.
- ▶ Bottom threaded hole: 9.3 mm.

訂購編號 Order No.	規格 Spec	H	H1	L	L1	R	R2	庫存 Stock	牌價 P	備註2 Remark2
KZKBT30	BT30	125	100	72	68	9.3	-		2800	
KZKBT40	BT40	125	100	72	68	9.3	-		2800	
KZKBT50	BT50	170	130	100	92	13.8	-		4420	
KZKHSK63	HSK63	200	-	80	-	-	63			Compatible with BT40

# DEBURRING TOOLS



## Specifications

- ▶ The handle is designed according to ergonomic principles.
- ▶ It is suitable for removing burrs, trimming, and deburring on all types of materials.
- ▶ This tool promotes a higher level of surface smoothness during processing, reducing the occurrence of burrs.

訂購編號 Order No.	規格 Spec	庫存 Stock	牌價 P	備註2 Remark2
PNOGABS2010	修整刀刃 BS2010			
PNOGASN1000	握柄夾具 NG1000			

■ Inventory products

# MECHANICAL EDGE FINDER



GE-1020



GE-420



GE-430

## Specifications

- ▶ Suitable for speed: 400-600RPM, body accuracy: 0.003-0.005mm.
- ▶ Suitable for various machine tools: conventional milling, power tools, engraving machines, and general-purpose machining.
- ▶ Anti-magnetic design, accurate measurement, fast analysis.

訂購編號 Order No.	規格 Spec	庫存 Stock	牌價 P	備註2 Remark2
KWMGE420	GE-420	■		
KWMGE430	GE-430	■		
KWMGE1020	GE-1020	■		

# CERAMIC EDGE FINDER

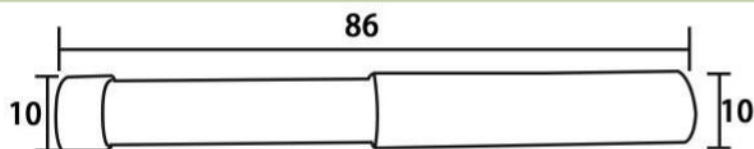

## Specifications

- ▶ It is wear-resistant and anti-static.
- ▶ The device possesses non-magnetic properties.
- ▶ With its brand-new all-ceramic tip, the probe achieves a precision of up to  $\pm 0.005\text{mm}$ .

訂購編號 Order No.	規格 Spec	庫存 Stock	牌價 P	備註2 Remark2
KWMOSK101C	OSK1010	■		

# 3D LONG/SHORT PROBE

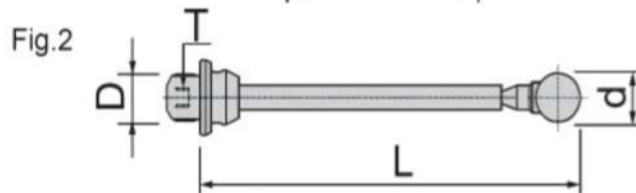
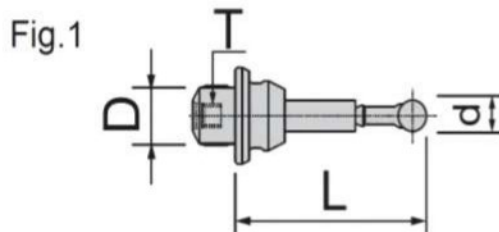

## Specifications

- ▶ The probe utilizes a new all-ceramic tip, achieving an accuracy of  $\pm 0.003\text{mm}$ .
- ▶ It possesses non-magnetic properties.
- ▶ It is wear-resistant and anti-static.

訂購編號 Order No.	規格 Spec	L	d	D	T	庫存 Stock	牌價 P	備註2 Remark2
KW3D01	探針(短)	25	4	Ø7.5	M3			
KW3D02	探針(長)	65	8	Ø7.5	M3			

■ Inventory products