

Asian Institute of Technology

Km. 42 Paholyothin Highway, Klong Luang, Pathumthani, Thailand 12120

P. O. Box 4 Klong Luang, Pathumthani 12120, Thailand. Tel. (66-2) 524-5527, 524-6427 Fax. (66-2) 524-5544

STRUCTURAL ENGINEERING LABORATORY STRUCTURAL ENGINEERING FIELD OF STUDY SCHOOL OF ENGINEERING AND TECHNOLOGY

TYPE OF TEST: TENSION TEST

TEST SPECIMEN: Two (2) specimens of coupler type "Roc Coupler" which connected two pieces of "EBM DB16 SD40 IF" deformed bar, were given by the client.

CLIENT: BENZSON INTERNATIONAL (THAILAND) CO., LTD.

DATE OF TEST : November 13, 2020

TEST MACHINE: The 200-ton "SHIMADZU" Universal Testing Machine of Type: UMH 200 A.

TEST RESULTS:

Specimen No.	Type of Deformed bar	Maximum Load (kgf)	Mode of Failure
1	EBM DB16 SD40 IF	11,730	Tensile failure of deformed bar.
2	EBM DB16 SD40 IF	11,610	Tensile failure of deformed bar.

Note : This report certifies the adequacy and representative character of the test sample only.

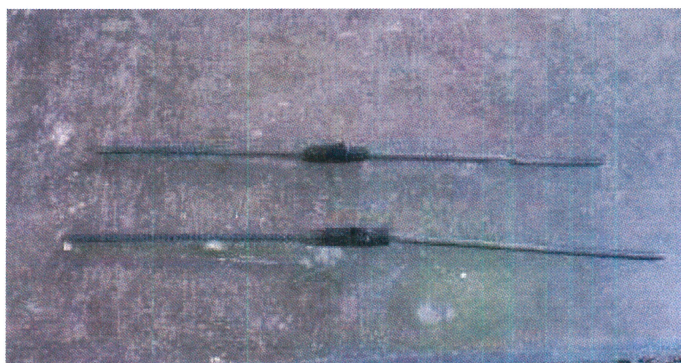

Figure 1 Tensile failure of deformed bar.

TESTED BY:

MR. NIKOM TANIL
TECHNICIAN

CHECKED & APPROVED BY:

DR. ANAWAT CHOTESUWAN
SENIOR LABORATORY SUPERVISOR
November 25, 2020

Asian Institute of Technology

Km. 42 Paholyothin Highway, Klong Luang, Pathumthani, Thailand 12120

P. O. Box 4 Klong Luang, Pathumthani 12120, Thailand. Tel. (66-2) 524-5527, 524-6427 Fax. (66-2) 524-5544

STRUCTURAL ENGINEERING LABORATORY STRUCTURAL ENGINEERING FIELD OF STUDY SCHOOL OF ENGINEERING AND TECHNOLOGY

TYPE OF TEST: TENSION TEST

TEST SPECIMEN: Two (2) specimens of coupler type "Roc Coupler" which connected two pieces of "SKY DB25 SD40T IF" deformed bar, were given by the client.

CLIENT: BENZON INTERNATIONAL (THAILAND) CO., LTD.

DATE OF TEST : September 30, 2020

TEST MACHINE: The 200-ton "SHIMADZU" Universal Testing Machine of Type: UMH 200 A.

TEST RESULTS:

Specimen No.	Type of Deformed bar	Maximum Load (kgf)	Mode of Failure
1	SKY DB25 SD40T IF	32,770	The failure occurred at the deformed bar when applied the maximum load.
2	SKY DB25 SD40T IF	32,570	The failure occurred at the deformed bar when applied the maximum load.

Note : This report certifies the adequacy and representative character of the test sample only.

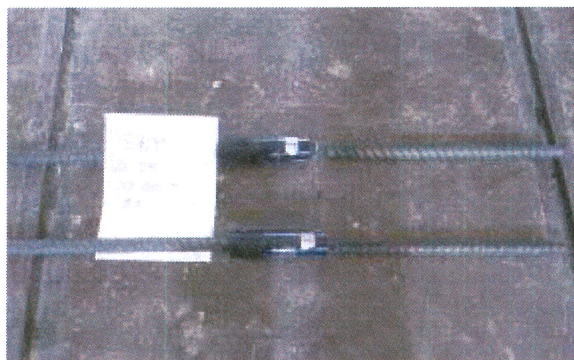

Figure 1 The failure occurred at the deformed bar when applied the maximum load.

TESTED BY:

Nikom Tanil
MR. NIKOM TANIL
TECHNICIAN

CHECKED & APPROVED BY:

Anawat Chotesuwan
DR. ANAWAT CHOTESUWAN
SENIOR LABORATORY SUPERVISOR
October 12, 2020